

NO.		DATE		BY		APP.	
XXXX		XXXX		XX		XX	
CONVEYED 25TH FROM 4 LANES TO 3, FULTON TO CALIFORNIA/LAKE DESCRIPTION							
TABLE OF REVISIONS CHECK WITH TRACKING TO SEE IF YOU HAVE LATEST REVISION							

REFERENCE INFORMATION & FILE NO. OF SURVEYS

SURVEYS
 STR-XXXX X
 STR-XXXX X
 STR-XXXX X
 STR-XXXX X
 STR-XXXX X



DEPARTMENT OF PARKING AND TRAFFIC
 DIVISION OF TRAFFIC ENGINEERING
 CITY AND COUNTY OF SAN FRANCISCO

DESIGNED:	DATE:
DP	11/07
DRAWN:	DATE:
EP	02/08
CHECKED:	DATE:
MW	03/08

APPROVED	DATE:
SECTION ENGINEER	DATE:
DEP. DIRECTOR AND CITY TRAFFIC ENGINEER	DATE:

SCALE:
1"=50'
SHEET OF SHEETS

PROPOSED TRAFFIC STRIPING
 TWENTY-FIFTH AVENUE
 EL CAMINO DEL MAR TO FULTON STREET

CONTRACT NO.
DRAWING NO.
STR-XXXX
FILE NO.
REV. NO.
0

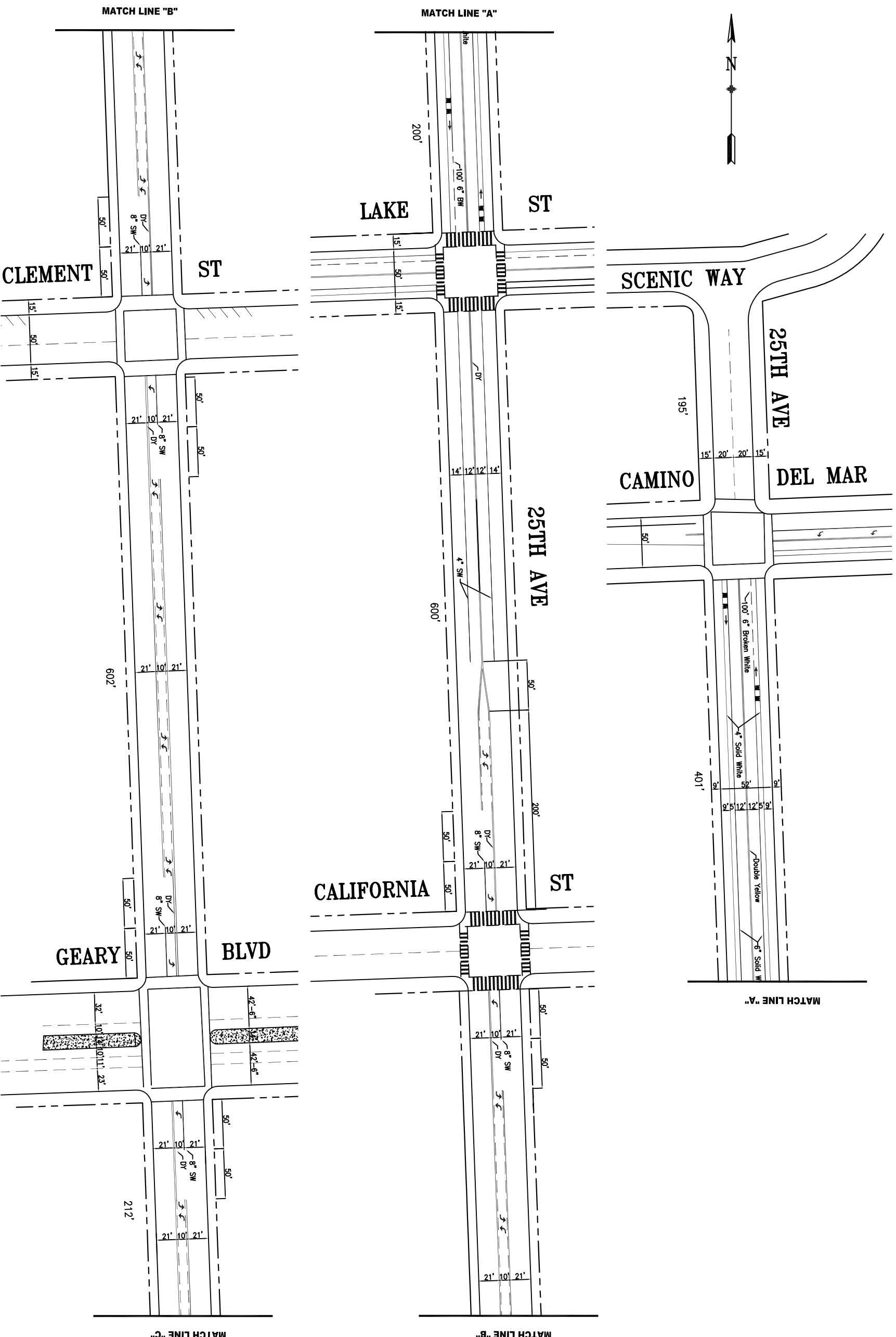

NO.	DATE	DESCRIPTION	BY	APP.
XXX		CONVERTED 25TH FROM 4 LANES TO 3, FULTON TO CALIFORNIA/LAKE	XX	XX

REFERENCE INFORMATION & FILE NO. OF SURVEYS	
SURVEYS	STR-XXX XX X
STR-XXX	XX X
STR-XXX	XX X
STR-XXX	XX X

DEPARTMENT OF PARKING AND TRAFFIC
 DIVISION OF TRAFFIC ENGINEERING
 CITY AND COUNTY OF SAN FRANCISCO

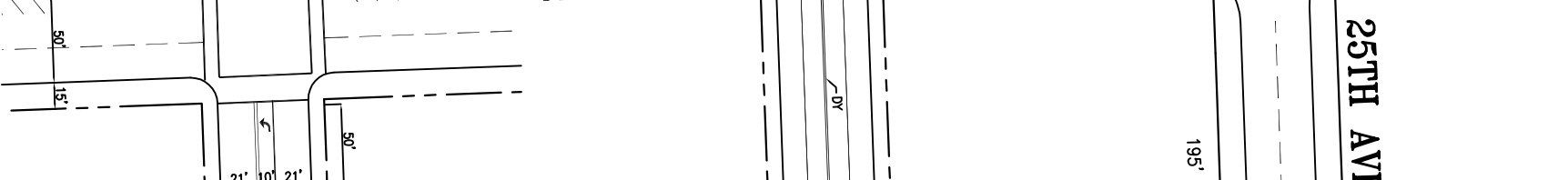

DESIGNED:	DATE:	APPROVED:	SCALE:
DP	11/07		1"=50'
DRAWN:	DATE:	SECTION ENGINEER	DATE:
EP	02/08		
CHECKED:	DATE:	DEP. DIRECTOR AND CITY TRAFFIC ENGINEER	DATE:
MW	03/08		

PROPOSED TRAFFIC STRIPING	
TWENTY-FIFTH AVENUE	
EL CAMINO DEL MAR TO FULTON STREET	

CONTRACT NO.	DRAWING NO.
	STR-XXXX
REV. NO.	FILE NO.
0	