

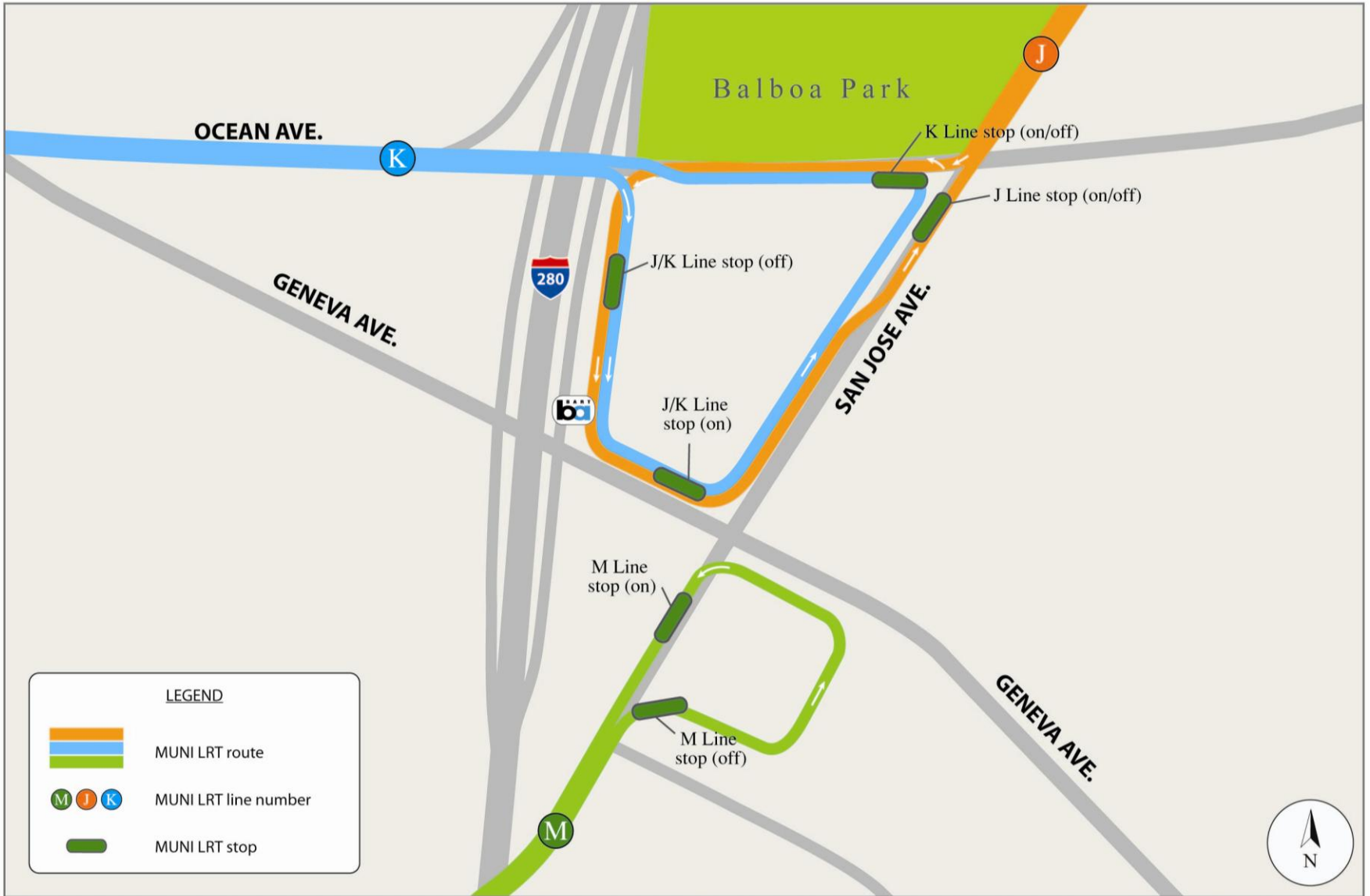

Green Light Rail Center Track Replacement Project



The Curtis E. Green Light Rail Center

- **Serves as a cleaning, electrical, painting, heavy repair, running repair, inspection and wheel truing shop**
- **Light rail terminus for the J and K/T lines**
- **Located in close proximity to the Balboa BART station**
- **Supports heavy pedestrian traffic during peak periods**

Project Goals

- **Enhance system reliability and efficiency**
- **Reduce infrastructure maintenance**

Scope of Work

Key components:

- **Replace worn storage track and switches**
- **Special track work in the yard**
- **Upgrade overhead contact system**
- **Upgrade electrical system**
- **Improve lighting within the yard**

Scope of Work (cont.)

- **Construction of a boarding island and ADA ramp platform at San Jose as an embarkation point for the J and K lines**
- **Landscape work around the yard next to the sidewalk along San Jose and Ocean Avenue**

Project Timeline

Activity	<i>Projected</i> Dates
Advertisement	January 2012
Bid and Award	May 2012
Notice to Proceed (NTP)	July 2012
Substantial Completion	July 2015

Project Phases

- **First phase of construction (*mid 2012*):**
 - Building of a boarding area and ADA key stop on San Jose Avenue
 - Emergency track work near the Maintenance Bldg.
- **Subsequent phases scheduled upon completion of first phase**

Current View of Future Boarding/Key Stop Area



Phase 1: Boarding Area & ADA Key Stop



San Jose Avenue

Phase 1: Close up: ADA Key Stop

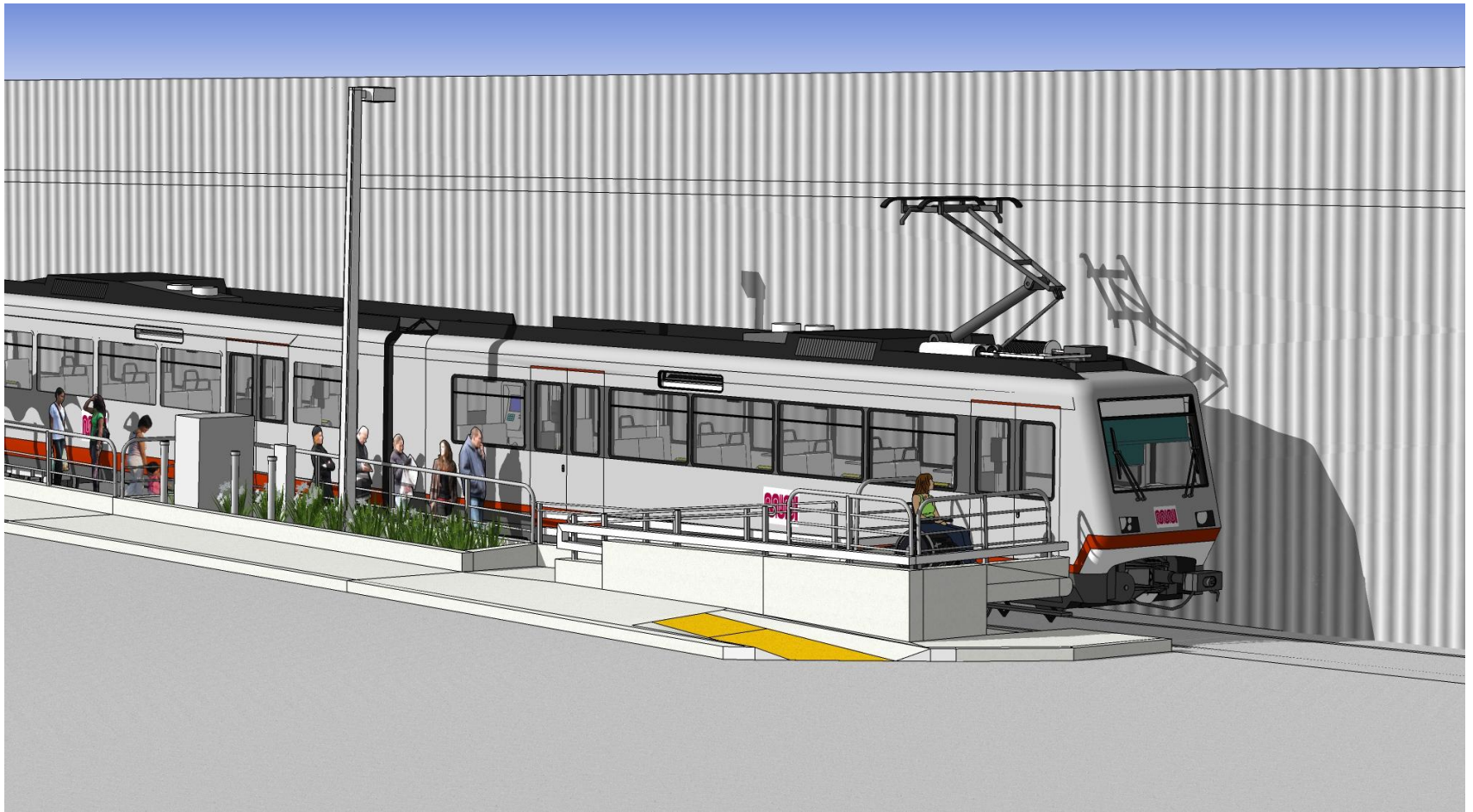

San Jose Avenue



BART/Muni Station Improvements

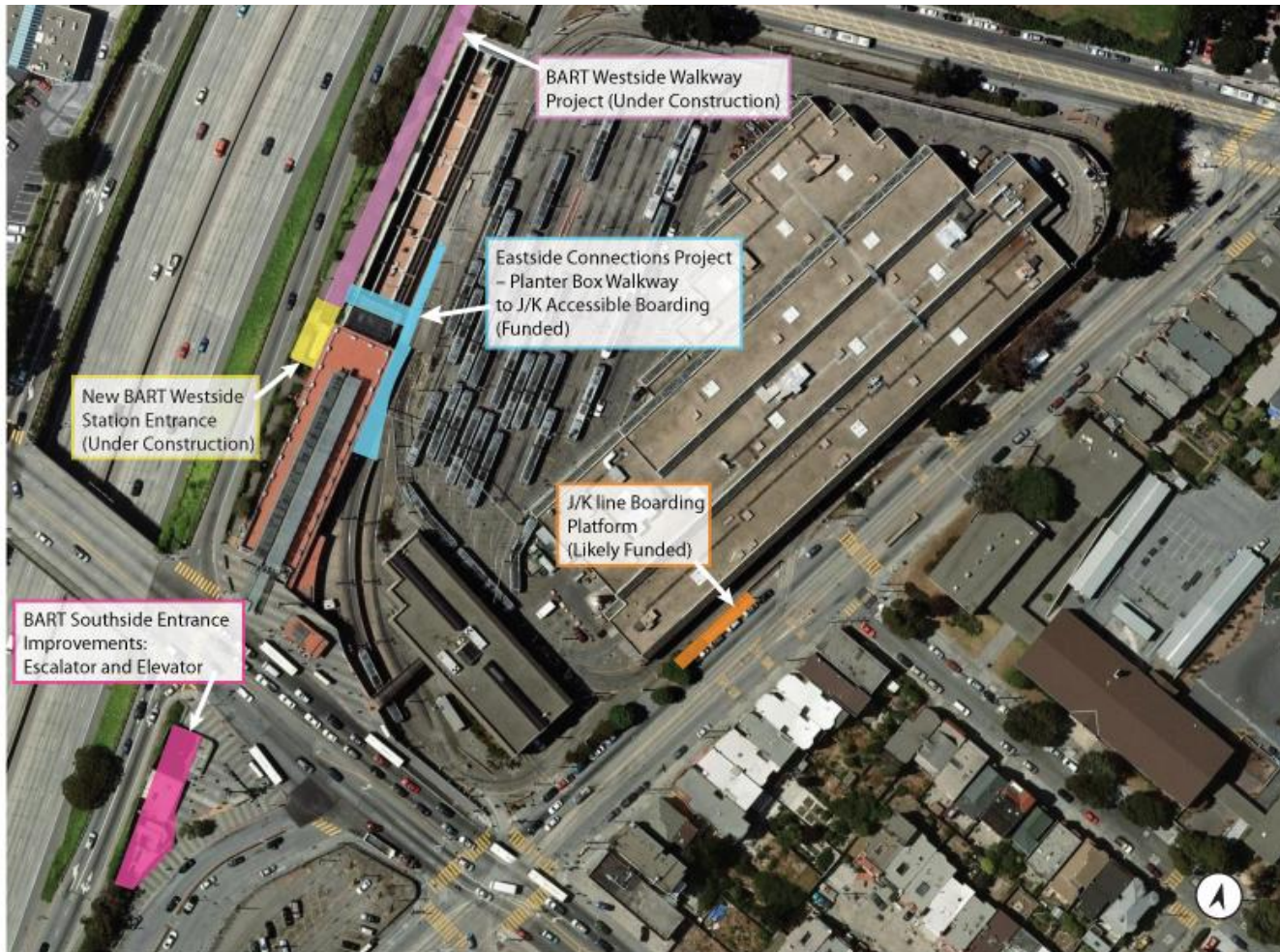

Balboa Park BART Station Eastside Connection Project



Balboa Park BART Station Eastside Connection Project



Balboa Park BART Station Eastside Connection Project



Landscape Plan

Existing Conditions and Proposed Site Furnishings



CORNER OF SAN JOSE AND OCEAN AVE LOOKING SOUTH



METRO STOP SAN JOSE AVENUE
TO RECEIVE BOARDING ISLAND



PROPOSED BENCHES



OCEAN AVENUE LOOKING EAST



METRO STOP - OCEAN AVE AT SAN JOSE

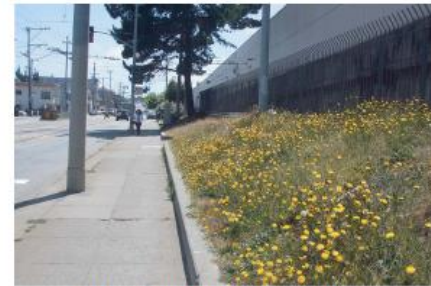

SAN JOSE AVENUE LOOKING SOUTH



SPECIAL PAVING TO MATCH EXISTING

PROPOSED
SITE FURNISHINGS

EXISTING CONDITIONS

GREEN LIGHT RAIL CENTER TRACK REPLACEMENT LANDSCAPE IMPROVEMENTS

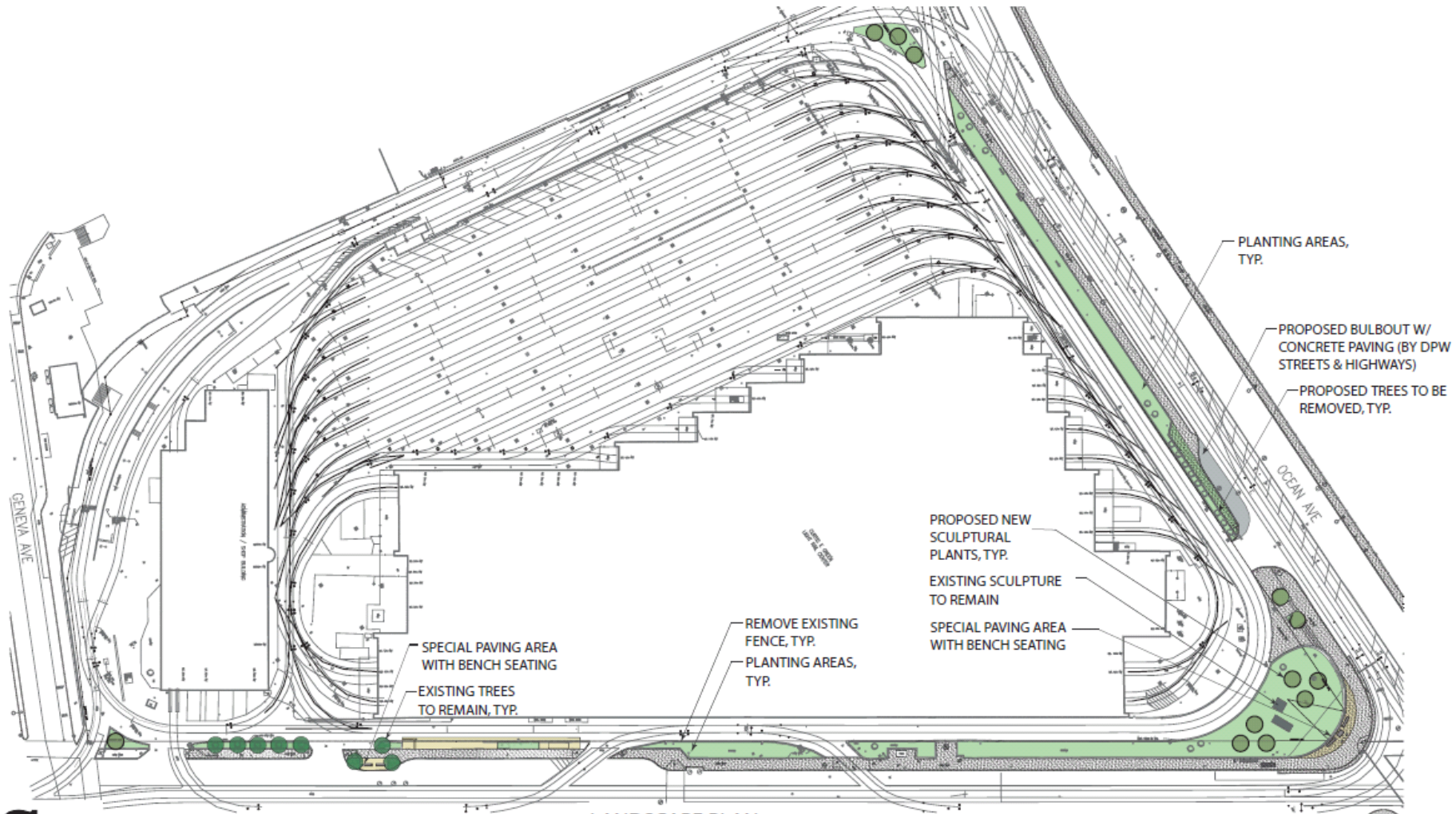

LANDSCAPE PLAN

GREEN LIGHT RAIL CENTER TRACK REPLACEMENT LANDSCAPE IMPROVEMENTS



SFDPW Landscape Architecture
June 2011

Proposed Landscape Palette: Option 1



CONCEPT IMAGE - CALIFORNIA PLANTS



MIMULUS AURANTIACUS



PENSTEMON 'MARGARITA BOP'

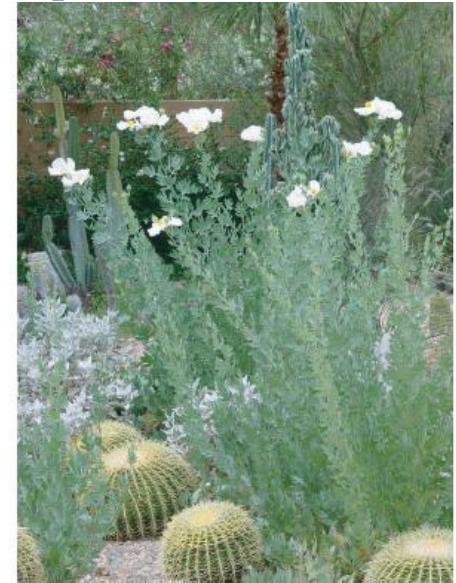

SCREENING SHRUB - ROMNEYA COULTERI



CEANOTHUS



ROMNEYA COULTERII - FLOWER



CEANOTHUS 'DIAMOND HEIGHTS'



FRAGARIA CHILOENSIS



ESCHSCHOLZIA CALIFORNICA



ACCENT PLANT - ARCTOSTAPHYLOS

OPTION 1 - CALIFORNIA PLANTS

GREEN LIGHT RAIL CENTER TRACK REPLACEMENT - PLANT PALETTE LANDSCAPE IMPROVEMENTS

Option 1: California Native Plants

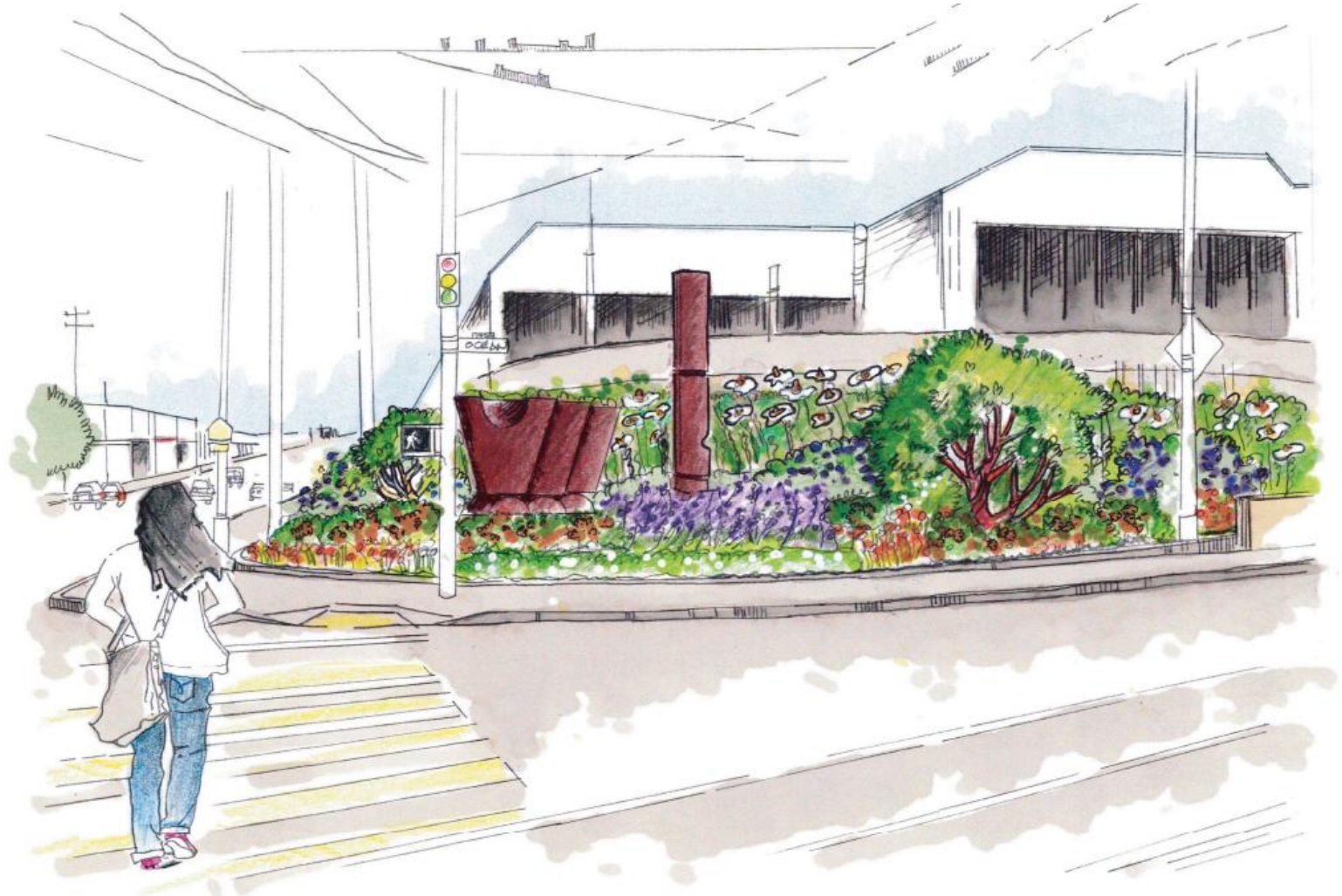

Proposed Landscape Palette: Option 2



CONCEPT IMAGE - VIBRANT COLOR



PHORMIUM 'YELLOW WAVE'



PHORMIUM 'DARK DELIGHT'



LEUCADENDRON 'SUMMER RED'



COLEONEMA 'SUNSET GOLD'



ACCENT TREE - AGONIS 'JERVIS BAY AFTERDARK'



SCREENING SHRUB - ARBUTUS 'MARINA'



KNIPHOFIA



PHORMIUM 'JESTER'



LEUCADENDRON 'WILSON'S WONDER'



COPROSMA 'RAINBOW SURPRISE'



CORDYLIN 'FESTIVAL BURGANDY'



AEONIUM SCHWARZKOPF



AEONIUM SUNBURST

OPTION 2 - VIBRANT COLOR

GREEN LIGHT RAIL CENTER TRACK REPLACEMENT - PLANT PALETTE LANDSCAPE IMPROVEMENTS

Option 2: Vibrant Color



Proposed Landscape Palette: Option 3



CONCEPT IMAGE - SCULPTURAL SUCCULENTS & GRASSES



AGAVE 'BLUE GLOW'



SCREENING SHRUB - PODOCARPUS 'ICEE BLUE'



VERBENA BONARIENSIS



OENOTHERA BERLANDIERI



YUCCA ROSTRATA



YUCCA 'JEWEL'



ACHILLEA MILLEFOLIUM ROSEA



ACCENT PLANT - AGAVE



FESTUCA 'ELUAH BLUE'



NASSELLA TENUISSIMA



AGAVE AMERICANA



YUCCA FILAMENTOSA

OPTION 3 - SCULPTURAL SUCCULENTS & GRASSES

GREEN LIGHT RAIL CENTER TRACK REPLACEMENT - PLANT PALETTE LANDSCAPE IMPROVEMENTS

Option 3: Sculptural Succulents & Grasses



What to Expect:

- **Construction equipment and crews**
- **Dust and noise**
- **Roofing project dust and noise**
- **Temporary street parking removal**
- **Periodic traffic lane closures and detours**

Measures to Minimize Inconveniences

- **Proactive notification and noise mitigation**
- **Traffic control officers on-site**
- **Signage to direct customers to transfer points**
- **SFMTA Ambassadors**

Coordinated, Multilingual Customer Information Campaign

- **Community Outreach**
- **Printed materials**
- **Dedicated web page www.sfmta.com/green**
- **Electronic messaging**
- **Signs and banners**
- **SFMTA Customer Service Ambassadors**
- **Customer communications in English, Chinese and Spanish**

Contact Information

Yingming Gu, P.E., Project Manager

- E-mail: yingming.gu@sfmta.com
- Phone: 415.701.4255

Jeannette Sanchez, Public Relations Officer

- E-mail: jeannette.sanchez@sfmta.com
- Phone: 415.701.4790



311: 中文 / Español / Français / 日本語 / 한국어 / Italiano /
русский / tiếng Việt / Tagalog /



Questions & Comments