



SFMTA

March 18, 2022

Engineering Public Hearing

<https://sfmta.com/enghearing>

Conference Line: 888-398-2342

Access Code: 8647385#

[SFMTA.com/ENGSpeakerCard](https://sfmta.com/ENGSpeakerCard)

Proposed Street Changes

How does a proposed street change get approved?

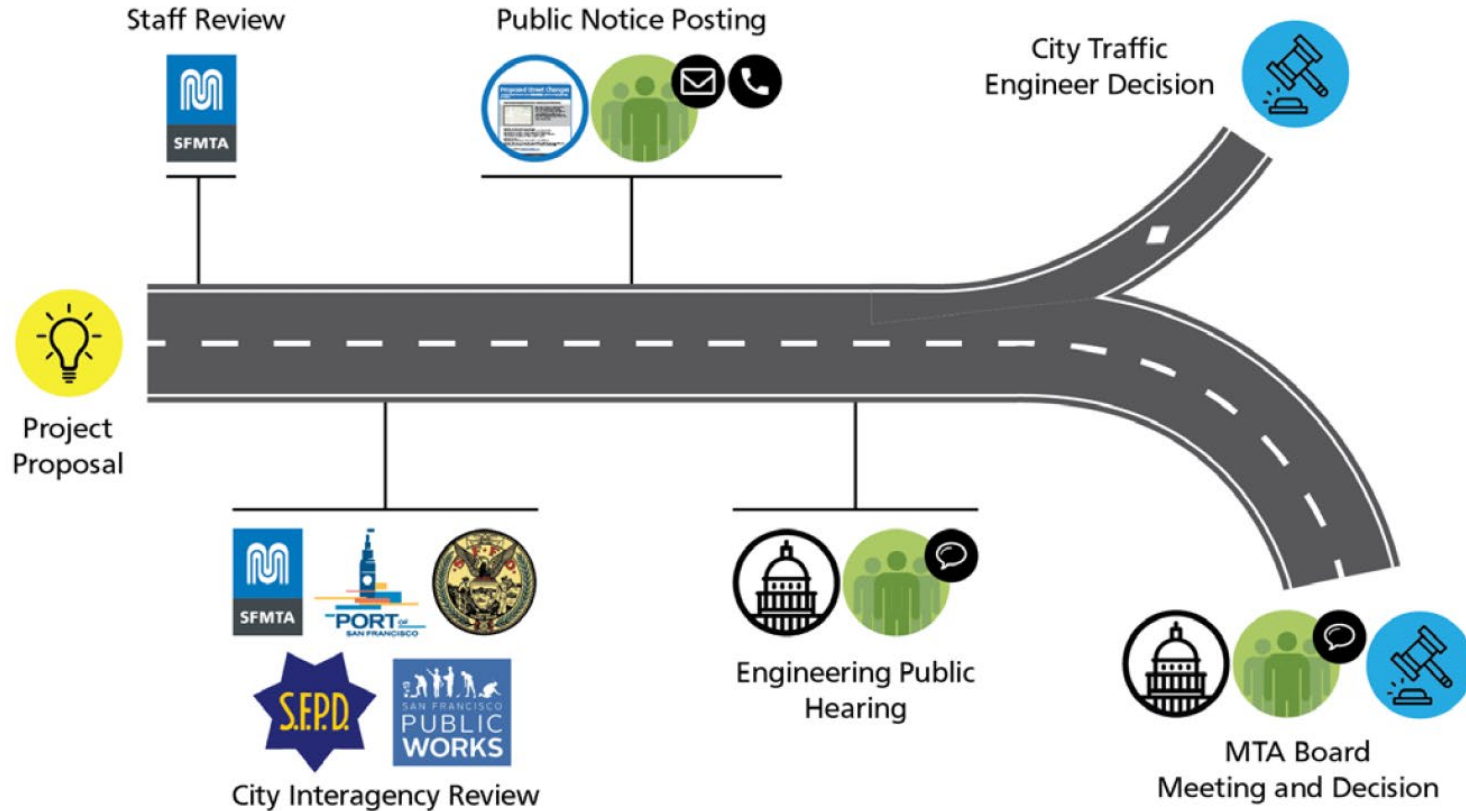

<https://www.sfmta.com/committees/engineering-public-hearings>

Public Hearing Decision Posting

Results will be posted by
5 PM next Friday

<https://www.sfmta.com/calendar/engineering-public-hearing-meeting-march-18-2022>

Referenced Materials

Engineering Public Hearing Agenda, December 17, 2021

 Engineering Public Hearing Agenda, December 17, 2021

 Engineering Public Hearing Results, December 17, 2021





SFMTA

March 18, 2022

Engineering Public Hearing

<https://sfmta.com/enghearing>

Conference Line: 888-398-2342

Access Code: 8647385#

[SFMTA.com/ENGSpeakerCard](https://sfmta.com/ENGSpeakerCard)

1. ESTABLISH - RESIDENTIAL PERMIT PARKING AREA Y

265-285 Main Street and 280 Spear Street, at the Corner of Folsom Street (Eligibility only, no signs)
(Supervisor District 6) (Requires approval by the SFMTA Board) Gerry Porras, gerry.porras@sfmta.com

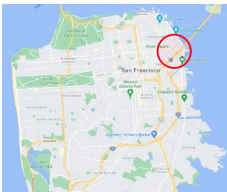

Conference Line: **1-888-398-2342** (use access code: 8647385)

To comment on an item, press "1" and then "0" when prompted.

2. ESTABLISH - RESIDENTIAL PERMIT PARKING AREA X

1231-1235 17th Street, East of Missouri Street (Eligibility only, no signs) (Supervisor District 10) (Requires approval by the SFMTA Board) Gerry Porras, gerry.porras@sfmta.com

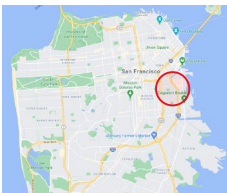

Conference Line: **1-888-398-2342** (use access code: 8647385)

To comment on an item, press "1" and then "0" when prompted.

3. ESTABLISH - RESIDENTIAL PERMIT PARKING AREA C

631 O'Farrell Street between Hyde Street and Leavenworth Street (Eligibility only, no signs) (Supervisor District 6) (Requires approval by the SFMTA Board) Gerry Porras, gerry.porras@sfmta.com

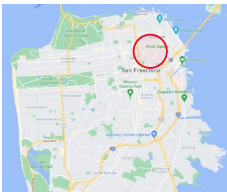

Conference Line: **1-888-398-2342** (use access code: 8647385)

To comment on an item, press "1" and then "0" when prompted.

4. ESTABLISH - RESIDENTIAL PERMIT PARKING AREA L

325-331 Balboa Street between 4th and 5th Avenues (Eligibility only, no signs) (Supervisor District 1)
(Requires approval by the SFMTA Board) Gerry Porras, gerry.porras@sfmta.com

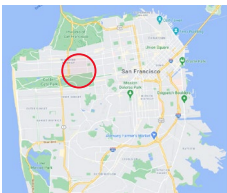

Conference Line: **1-888-398-2342** (use access code: 8647385)

To comment on an item, press "1" and then "0" when prompted.

5. ESTABLISH - RESIDENTIAL PERMIT PARKING AREA L

330-350 Balboa Street between 4th and 5th Avenues (Eligibility only, no signs) (Supervisor District 1)
(Requires approval by the SFMTA Board) Gerry Porras, gerry.porras@sfmta.com

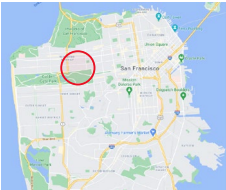

Conference Line: **1-888-398-2342** (use access code: 8647385)

To comment on an item, press "1" and then "0" when prompted.

6. ESTABLISH - RESIDENTIAL PERMIT PARKING AREA R/HV*

347-351 Hayes Street, West of Franklin Street (Eligibility only, no signs) (Supervisor District 5) (Requires approval by the SFMTA Board) Gerry Porras, gerry.porras@sfmta.com

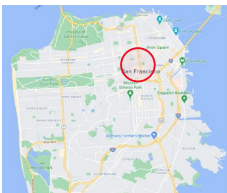

Conference Line: **1-888-398-2342** (use access code: 8647385)

To comment on an item, press "1" and then "0" when prompted.

7. ESTABLISH - RESIDENTIAL PERMIT PARKING AREA J

635-641 Irving Street, East of 8th Avenue (Eligibility only, no signs) (Supervisor District 5) (Requires approval by the SFMTA Board) Gerry Porras, gerry.porras@sfmta.com

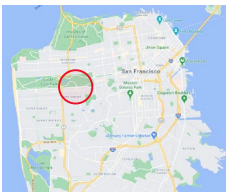

Conference Line: **1-888-398-2342** (use access code: 8647385)

To comment on an item, press "1" and then "0" when prompted.

8. ESTABLISH - RESIDENTIAL PERMIT PARKING AREA C

930 Post Street Between Larkin and Hyde Streets (Eligibility only, no signs) (Supervisor District 3) (Requires approval by the SFMTA Board) Gerry Porras, gerry.porras@sfmta.com

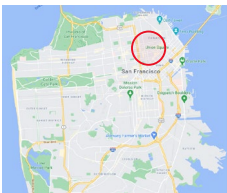
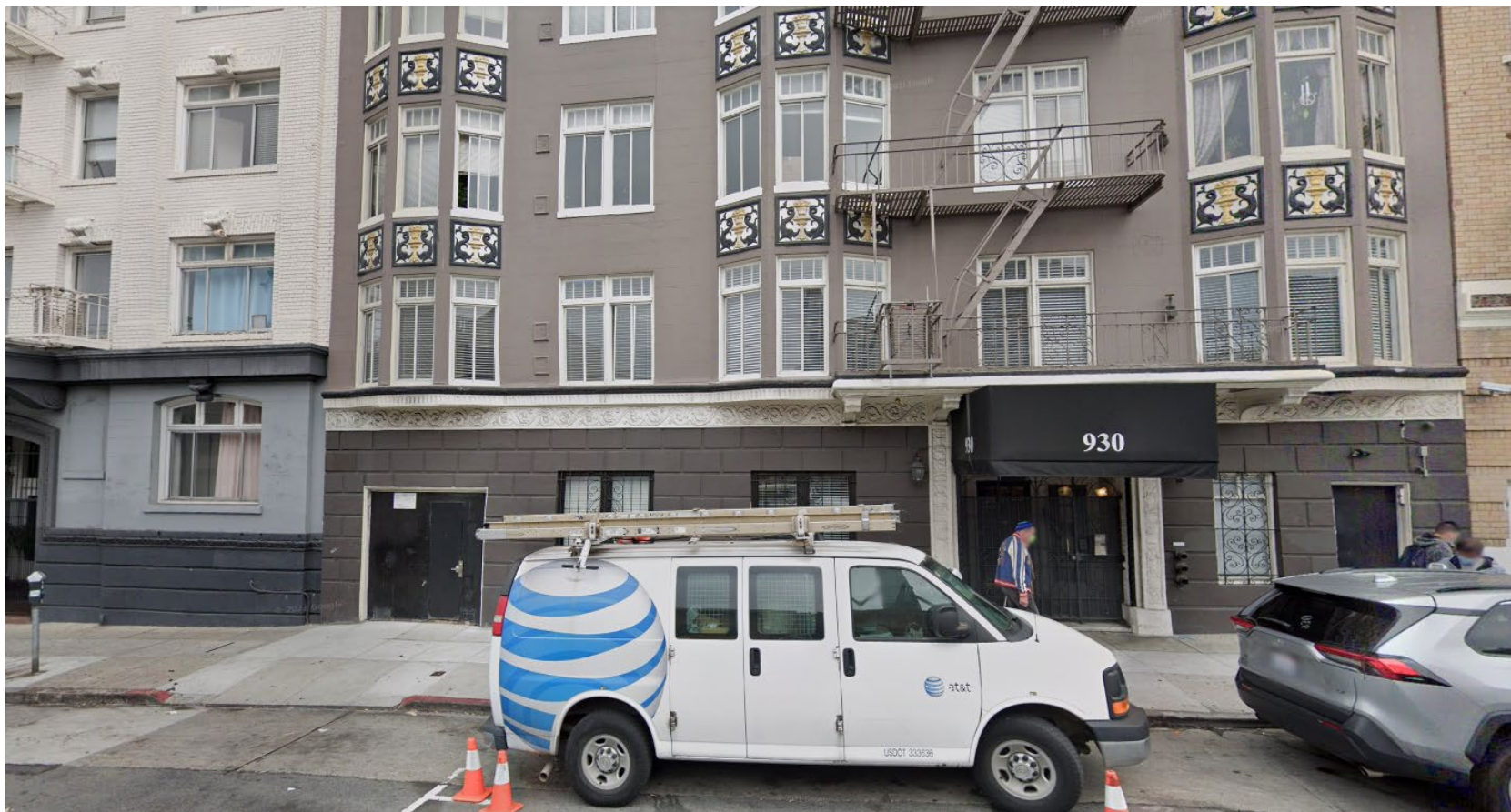

Conference Line: **1-888-398-2342** (use access code: 8647385)

To comment on an item, press "1" and then "0" when prompted.

**9. ESTABLISH RESIDENTIAL PERMIT PARKING AREA N
ESTABLISH - 2-HOUR PARKING, 9 AM TO 6 PM, MONDAY THROUGH FRIDAY, EXCEPT VEHICLES WITH AREA
N PERMITS**

**Anza Street, both sides, between 9th and 10th Avenue (Supervisor District 1) (Requires approval by the
SFMTA Board) Gerry Porras, gerry.porras@sfmta.com**

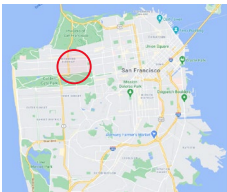
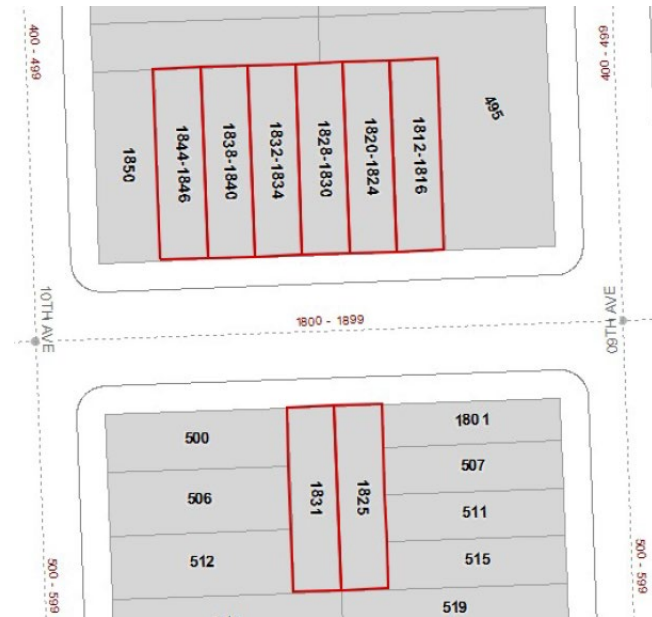
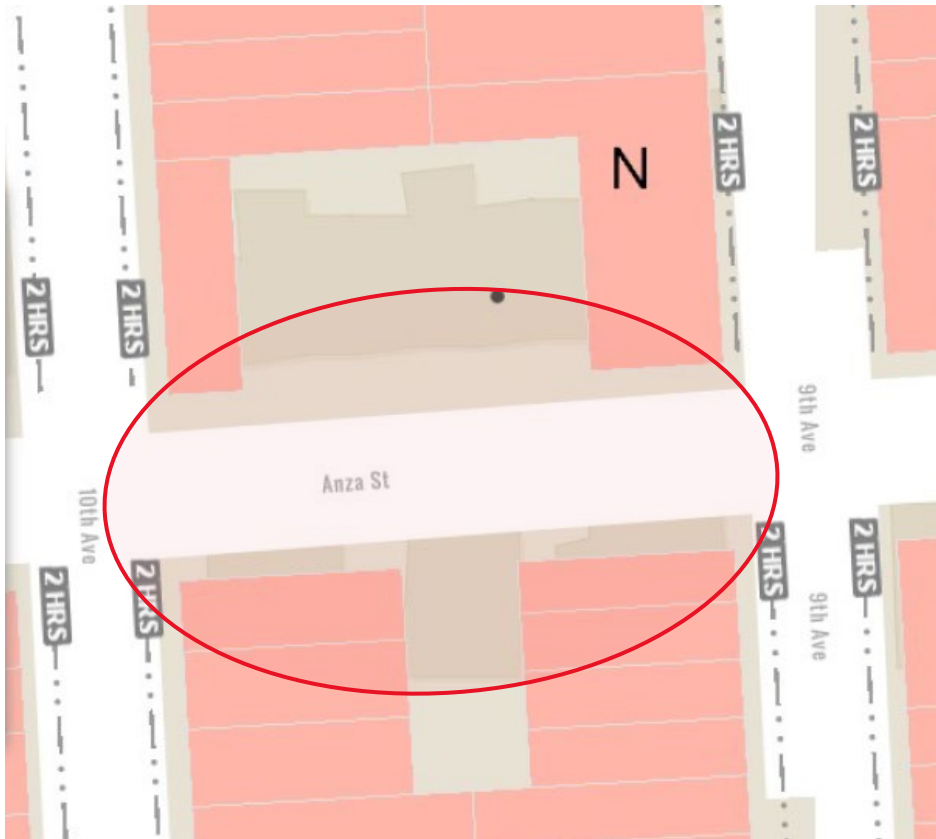

Conference Line: **1-888-398-2342** (use access code: 8647385)

To comment on an item, press "1" and then "0" when prompted.

10. ESTABLISH - RESIDENTIAL PERMIT PARKING AREA S
ESTABLISH - 2-HOUR PARKING, BOTH SIDES, 8 AM TO 9 PM, MONDAY THROUGH FRIDAY, EXCEPT
VEHICLES WITH AREA S PERMIT

Upper Terrace, both sides, between Masonic Ave and Buena Vista Ave E (Supervisor District 8) (Requires approval by the SFMTA Board) Gerry Porras, gerry.porras@sfmta.com

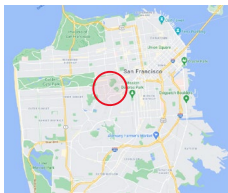
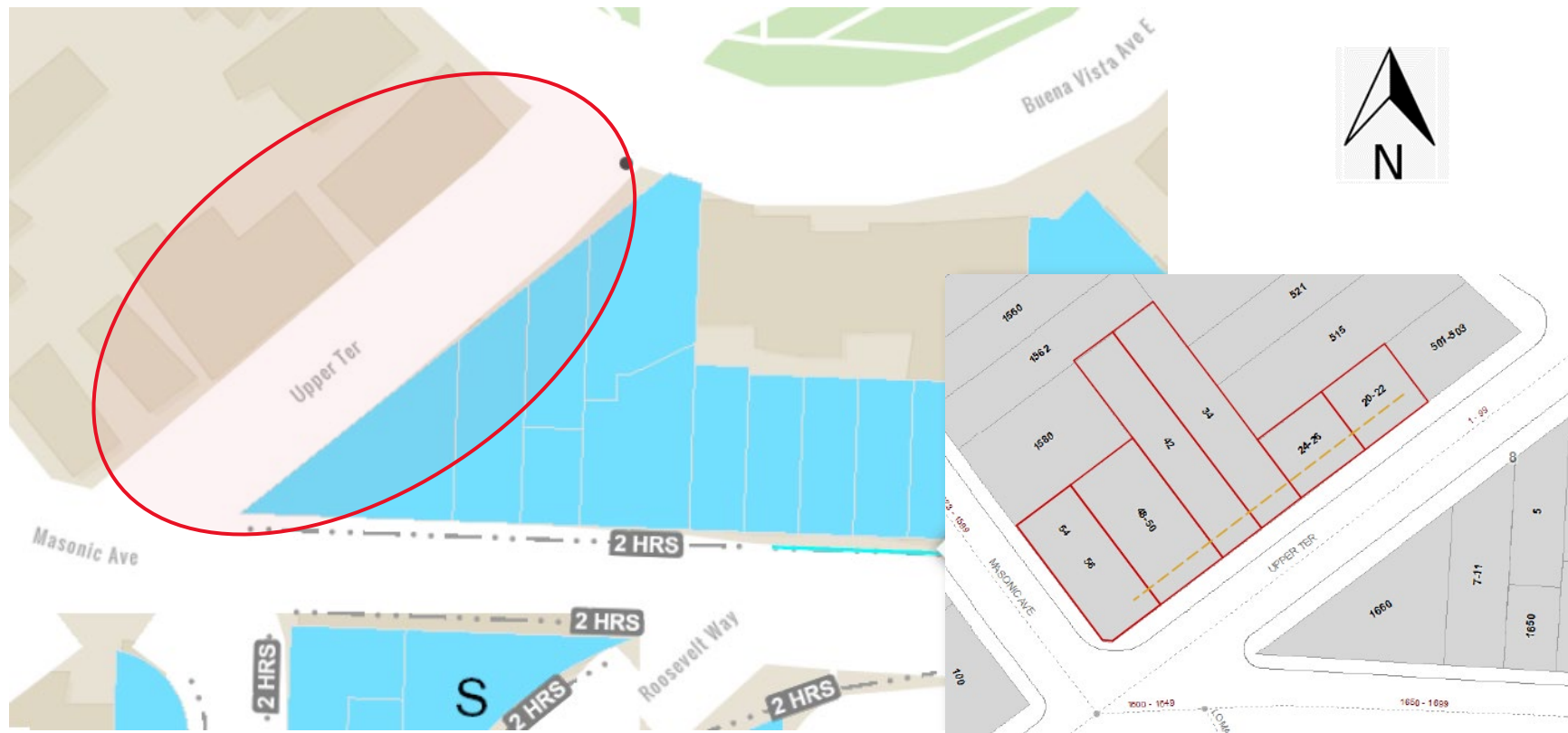

Conference Line: **1-888-398-2342** (use access code: 8647385)

To comment on an item, press "1" and then "0" when prompted.

11. ESTABLISH – PERPENDICULAR PARKING

Divisadero Street, west side, from Vallejo Street to Broadway (Supervisor District 2) (Requires approval by the SFMTA Board) Amy Chun, amy.chun@sfmta.com

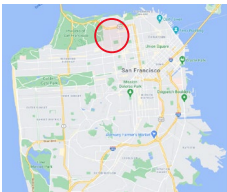
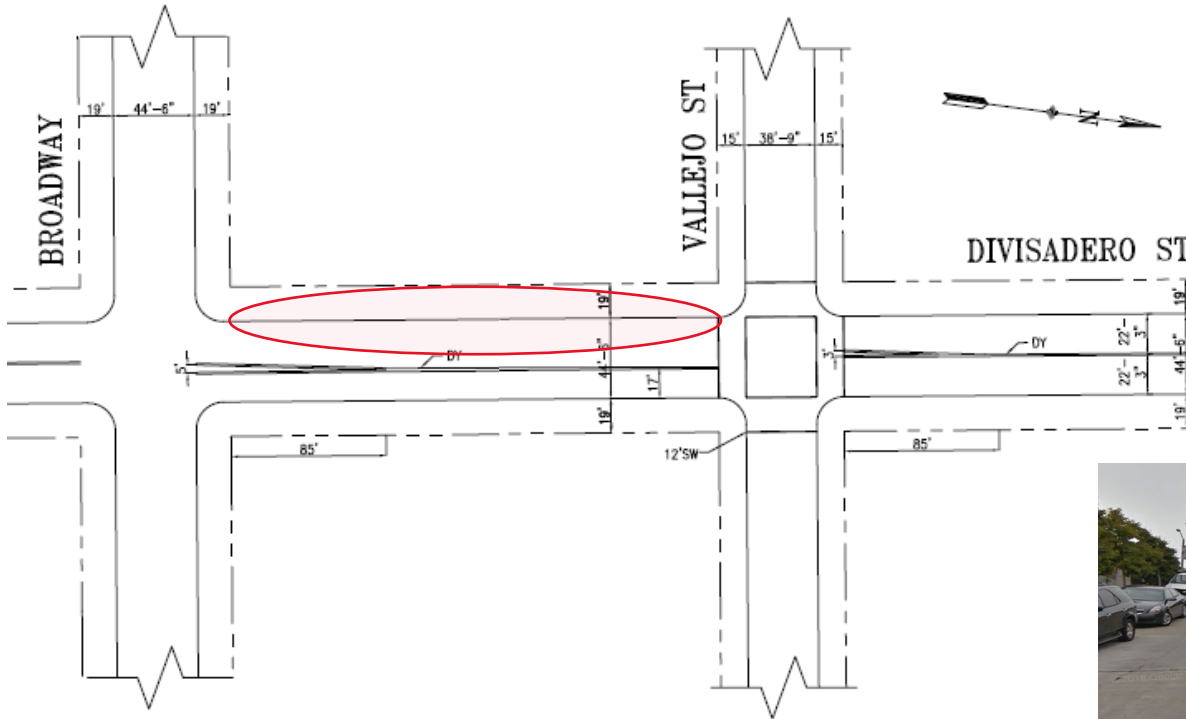

Conference Line: **1-888-398-2342** (use access code: 8647385)

To comment on an item, press "1" and then "0" when prompted.

**13. RESCIND – 25 MPH SPEED LIMIT
ESTABLISH – 20 MPH SPEED LIMIT**

1. Clement Street, between Funston Avenue and Arguello Boulevard (Supervisor District 1)
2. Columbus Avenue, between Washington Street and North Point (Supervisor Districts 2 and 3)
3. Geary Street, between Mason Street and Market Street (Supervisor District 3)
4. Post Street, between Mason Street and Market Street (Supervisor District 3)
5. Powell Street, between Bush Street and Ellis Street (Supervisor District 3)
6. Stockton Street, between Sacramento Street and Filbert Street (Supervisor District 3)
7. Taraval Street, between 17th Avenue and 26th Avenue (Supervisor District 4 and 7)
8. Hayes Street, between Franklin Street and Laguna Street (Supervisor District 5)
9. Diamond Street, between Chenery Street and Bosworth Street (Supervisor District 8)
10. Cortland Avenue, between Bonview Street and Folsom Street (Supervisor District 9)
11. Leland Avenue, between Bayshore Boulevard and Alpha Street (Supervisor District 10)
12. Mission Street, between Foote Avenue and Silver Avenue (Supervisor District 11)

(Requires approval by the SFMTA Board) Jeffrey Tom, Jeffrey.tom@sfmta.com

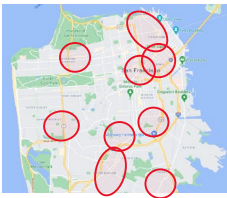

Conference Line: **1-888-398-2342** (use access code: 8647385)

To comment on an item, press "1" and then "0" when prompted.

13. RESCIND – 25 MPH SPEED LIMIT ESTABLISH – 20 MPH SPEED LIMIT



Proposed Business Activity District Speed Limit Reductions

March 2022

 Proposed 20 MPH Corridor

 0.5 miles
Scale 1:46,171

By downloading this map, you are agreeing to the following disclaimer: "The City and County of San Francisco ("City") provides the following data as a public record and no rights of any kind are granted to any person by the City's provision of this data. The City and County of San Francisco ("City") makes no representation regarding and does not guarantee or otherwise warrant the accuracy or completeness of this data. Anyone who uses this data for any purpose whatsoever does so entirely at their own risk. The City shall not be liable or otherwise responsible for any loss, harm, claim or action of any kind from any person arising from the use of this data. By accessing this data, the person accessing it acknowledges that she or he has read and does so under the condition that she or he agrees to the contents and terms of this disclaimer."

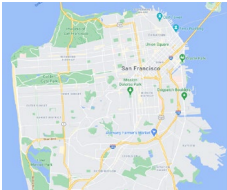



Conference Line: **1-888-398-2342** (use access code: 8647385)
To comment on an item, press "1" and then "0" when prompted.



<https://www.sfmta.com/getting-around/bike/bike-share>

Shortcut!

Google

 sfmta.com/bikeshare 

Quick Links

[Overview](#) | [Equity](#) | [Bikeshare's Purpose](#) | [System Planning and Station Siting](#) | [Bay Area Bike Share Pilot](#) | [Stationless Bikeshare](#) | [Bikeshare Data](#)

**14. ESTABLISH – NO STOPPING EXCEPT BICYCLES
ESTABLISH – BIKE SHARE STATION**

Pierce Street, east side, from Chestnut Street to 48 feet southerly (43-foot bike share station in parking lane with red zones on either side) (Supervisor District 2) (Approvable by the City Traffic Engineer) Laura Stonehill, laura.stonehill@sfmta.com

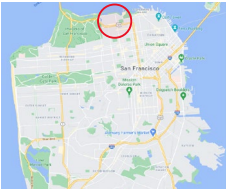
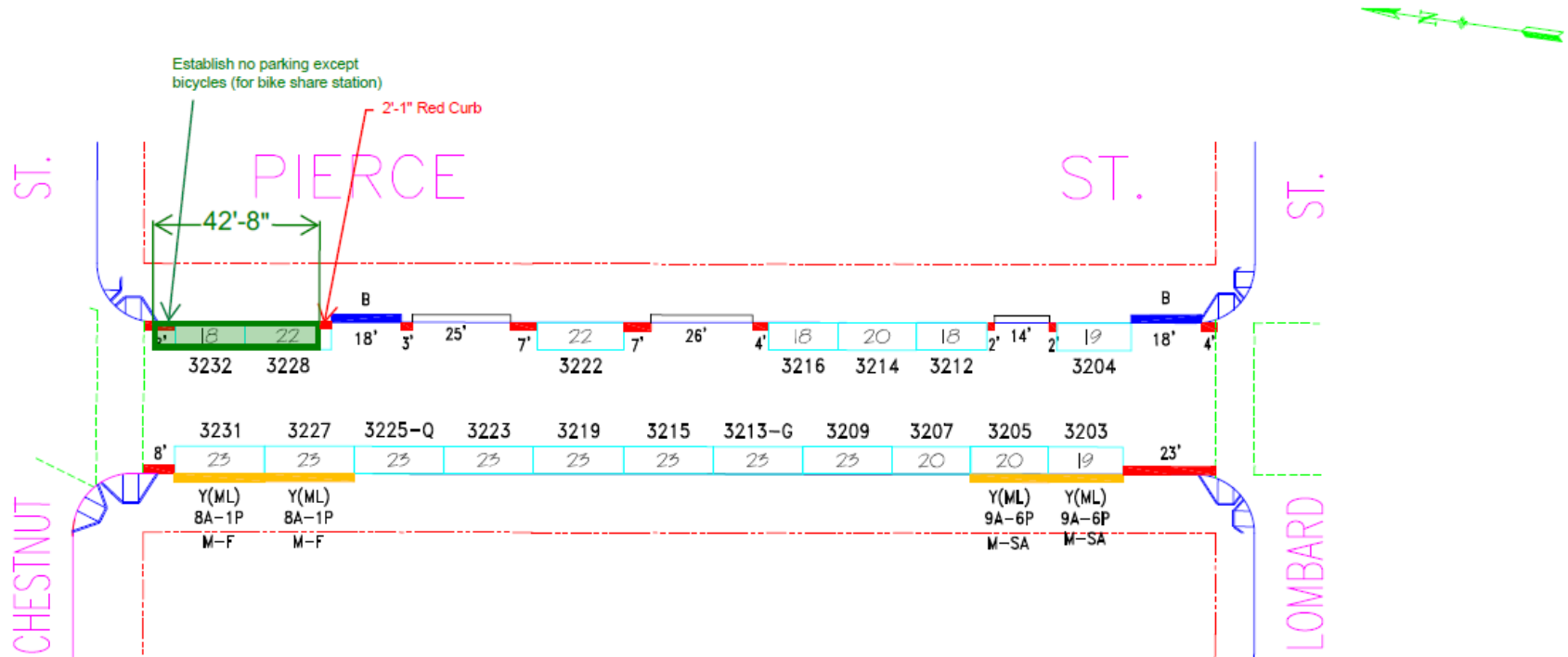

Conference Line: **1-888-398-2342** (use access code: 8647385)

To comment on an item, press "1" and then "0" when prompted.

**15. ESTABLISH – NO STOPPING EXCEPT BICYCLES
ESTABLISH – BIKE SHARE STATION**

Divisadero Street, west side, from 24 feet to 84 feet north of Lombard Street (60-foot bike share station in parking lane) (Supervisor District 2) (Approvable by the City Traffic Engineer) Laura Stonehill, laura.stonehill@sfmta.com

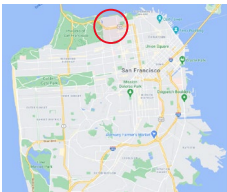
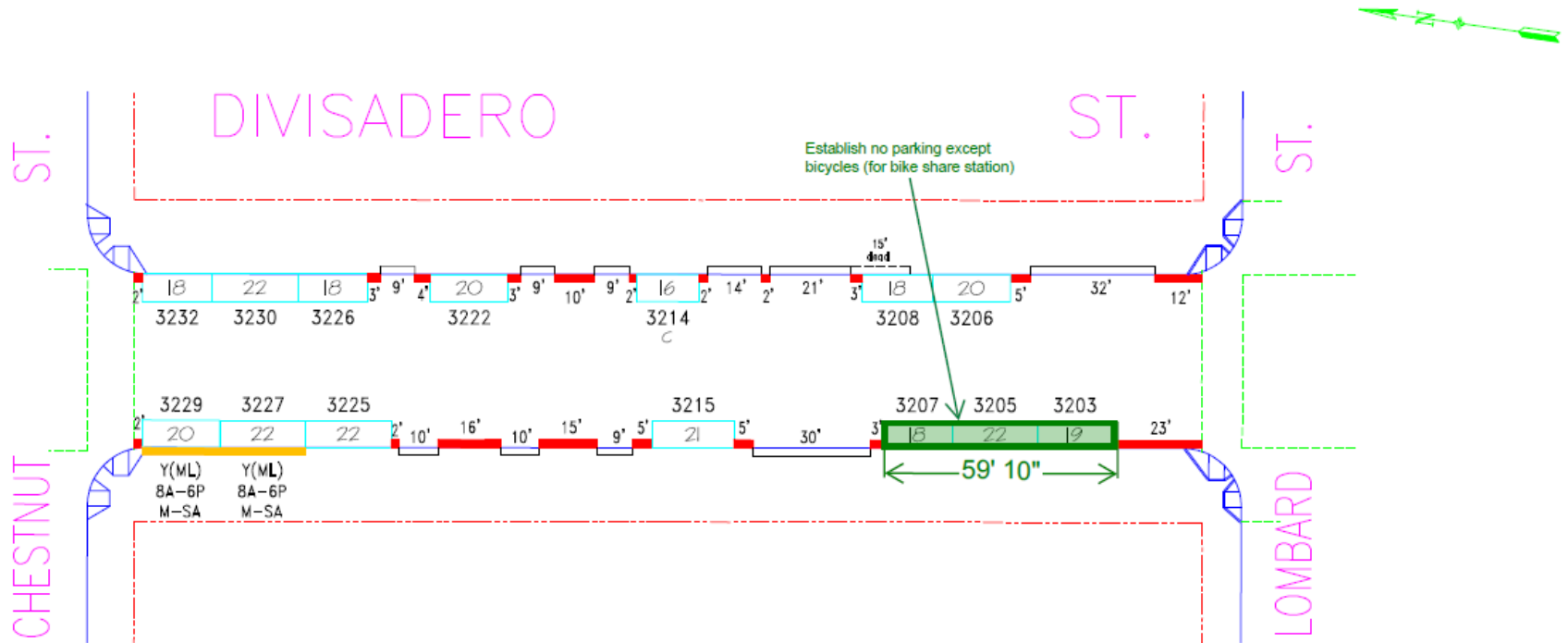

Conference Line: **1-888-398-2342** (use access code: 8647385)

To comment on an item, press "1" and then "0" when prompted.

PUBLIC COMMENT

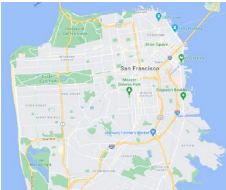

Conference Line: **1-888-398-2342** (use access code: 8647385)

To comment on an item, press "1" and then "0" when prompted.

Public Hearing Decision Posting

Results will be posted by
5 PM next Friday

<https://www.sfmta.com/calendar/engineering-public-hearing-meeting-march-18-2022>

Referenced Materials

Engineering Public Hearing Agenda, December 17, 2021

 Engineering Public Hearing Agenda, December 17, 2021

 Engineering Public Hearing Results, December 17, 2021





SFMTA

Next Engineering Public Hearing April 8, 2022

<https://sfmta.com/enghearing>

Conference Line: 888-398-2342

Access Code: 8647385#