

SFMTA - TASC SUMMARY SHEET

PreStaff_Date: 11/3/2020 Requested_by: SFMTA Handled: Eric Luu, 646-4311 Section Head : Bryant Woo	<input type="checkbox"/> Public Hearing Consent <input checked="" type="checkbox"/> Public Hearing Regular <input type="checkbox"/> Informational / Other <small>PH - Regular</small>	No objections: _____ Item Held: _____ Other: _____
---	---	---

Location: Buchanan Street and Golden Gate Avenue

Subject: New Traffic Signal

PROPOSAL / REQUEST:
 ESTABLISH – TRAFFIC SIGNAL
 Buchanan Street and Golden Gate Avenue

(Supervisor District 5)

As part of Western Addition Traffic Signal Upgrades, replaces existing flashing yellow beacons with new traffic signals to clearly establish pedestrian right-of-way, address a possible multiple-threat condition (Golden Gate Avenue is one-way with 3 eastbound lanes), and take advantage of progression-based traffic calming. The installation will include all necessary signal infrastructure including poles, signals, accessible pedestrian signals, and lighting in addition to standardized new signal treatments such as advance limit lines.

Eric Luu, eric.luu@sfmta.com

BACKGROUND INFORMATION / COMMENTS

New traffic signal as part of Western Addition Traffic Signal Upgrades.

Golden Gate Avenue ADT = 12,296 veh
 Buchanan Street ADT = 0 veh (midblock crossing)
 Collision Rate = 0.09
 No Muni routes travel through intersection.

HEARING NOTIFICATION AND PROCESSING NOTES:	ENVIRONMENTAL CLEARANCE BY: <input checked="" type="checkbox"/> SFMTA <input type="checkbox"/> Attached <input type="checkbox"/> Pending
---	--

CHECK IF PREPARING SEPARATE SFMTA BOARD CALENDAR ITEM FOR PROPOSAL:

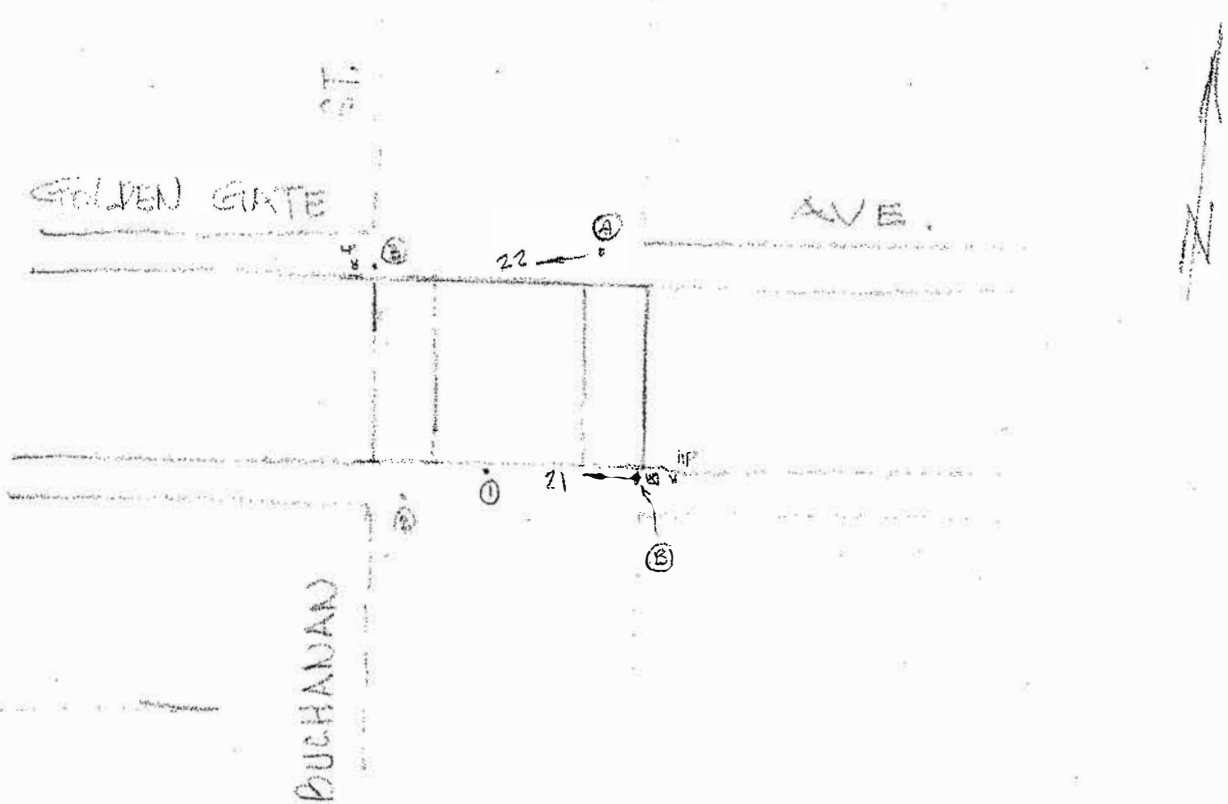

10/2/03

POLE	FUNC.	MAT'L	SIGNAL NO.	MAKE	NO. OF SECT.	SIZE	VISOR	B.P. OR LOUVERS	MOUN'T	PED SIGNAL NO.	LEGEND	MESSAGE		MAKE	MOUN'T
												ELEMENT	COLOR		
A	S	C	21		1	12" Y	T	NO	T						
B	S	C	22		1	12" Y	T	NO	T						
1	L	C													
2	S	C													
3	S	C													

CONTROLLER CABINET SIZE : STD BASE CABINET : _____

COMMENTS :

EXISTING CONDITIONS

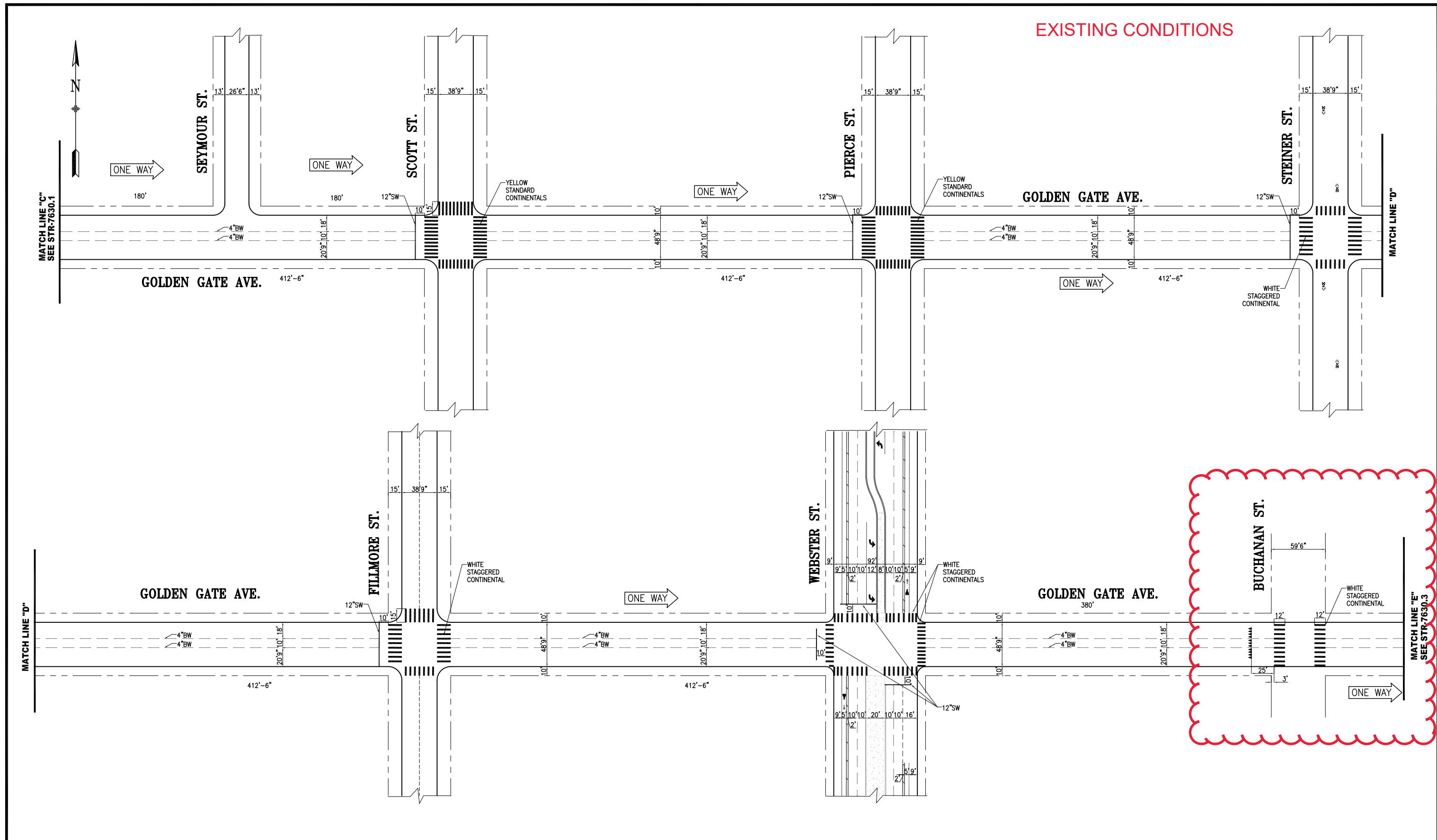

NO.	DATE	DESCRIPTION	BY	APP
1	10/26/18	INSTALL ADV LIMIT LINES ON WEBSTER & GOLDEN GATE INTERSECTION	M.SALLABERY	M.SALLABERY
2	09/10/18	WHITE STAGG CONT'S @ STEINER, FILLMORE; ALL @ SCOTT, PIERCE, STEINER, FILLMORE; PER FIELD: CONT'S ON STEINER	J.CHIMENTO	M.GROWNEY
3	07/06/18	WHITE STAGGERED CONTINENTALS AND YIELD TRIANGLES AT BUCHANAN ST	J.BANKS	G.DeLEON
4	03/31/18	PER FIELD: YELLOW CONTINENTALS AT SCOTT AND PIERCE STS	J.BANKS	G.DeLEON
5	-	WHITE STAGGERED CONTINENTAL XWALK AT WEBSTER ST	M.SALLABERY	M.SALLABERY

TABLE OF REVISIONS
CHECK WITH TRACING TO SEE IF YOU HAVE LATEST REVISION



SUPERCEDES STR-1841, REV4		APPROVED		SCALE:
DRAWN:	DATE:	KWAN L WOO 05/08/02		1" = 50'
D.YEUNG	05/2001	SENIOR ENGINEER		
CHECKED:	DATE:	BOND YEE 05/08/02		SHEET/SHEETS:
A.WONG	05/2001	CITY TRAFFIC ENGINEER		03 OF 05

STRIPING DRAWING		CONTRACT NO.
GOLDEN GATE AVENUE		DRAWING NO.
DIVISADERO STREET TO BUCHANAN STREET		STR-7630.2
		FILE NO.
		REV. NO.
		5

FILE NAME: ---
DATE: ---

EXISTING TIMING

Buchanan and Golden Gate

DESCRIPTION: Removed signal heads facing Buchanan

CHANGE 12
Intersection No. n/a
ENGINEER: Ricardo Olea

NOTES:

PHASE A	STREET NAME Golden Gate EB	FLASH Y	Controller: Cabinet Operation Date: 6/30/1955 System: Master: Cascade:
------------	-------------------------------	------------	---

ELECTRICIAN BM/PN
1105
Date Completed: 9/19/2003

**OPERATION TIMES
PLAN ONE (1)**

X = YES -- = NO	S	M	T	W	T	F	S	CYCLE	SPLIT	OFFSET	FLASH
AT ALL TIMES	X	X	X	X	X	X	X	--	--	--	X

STREET	PHASE	1	2	3	4	5	6	7	8	9	10	11	12	13	14	15
Golden Gate EB	FY															
FY = Flashing Yellow																

CSO	CYCLE (seconds)	OFFSET (seconds)	SIGNAL INTERVALS (seconds)														
			1	2	3	4	5	6	7	8	9	10	11	12	13	14	15

Buchanan and Golden Gate

CHANGE 12

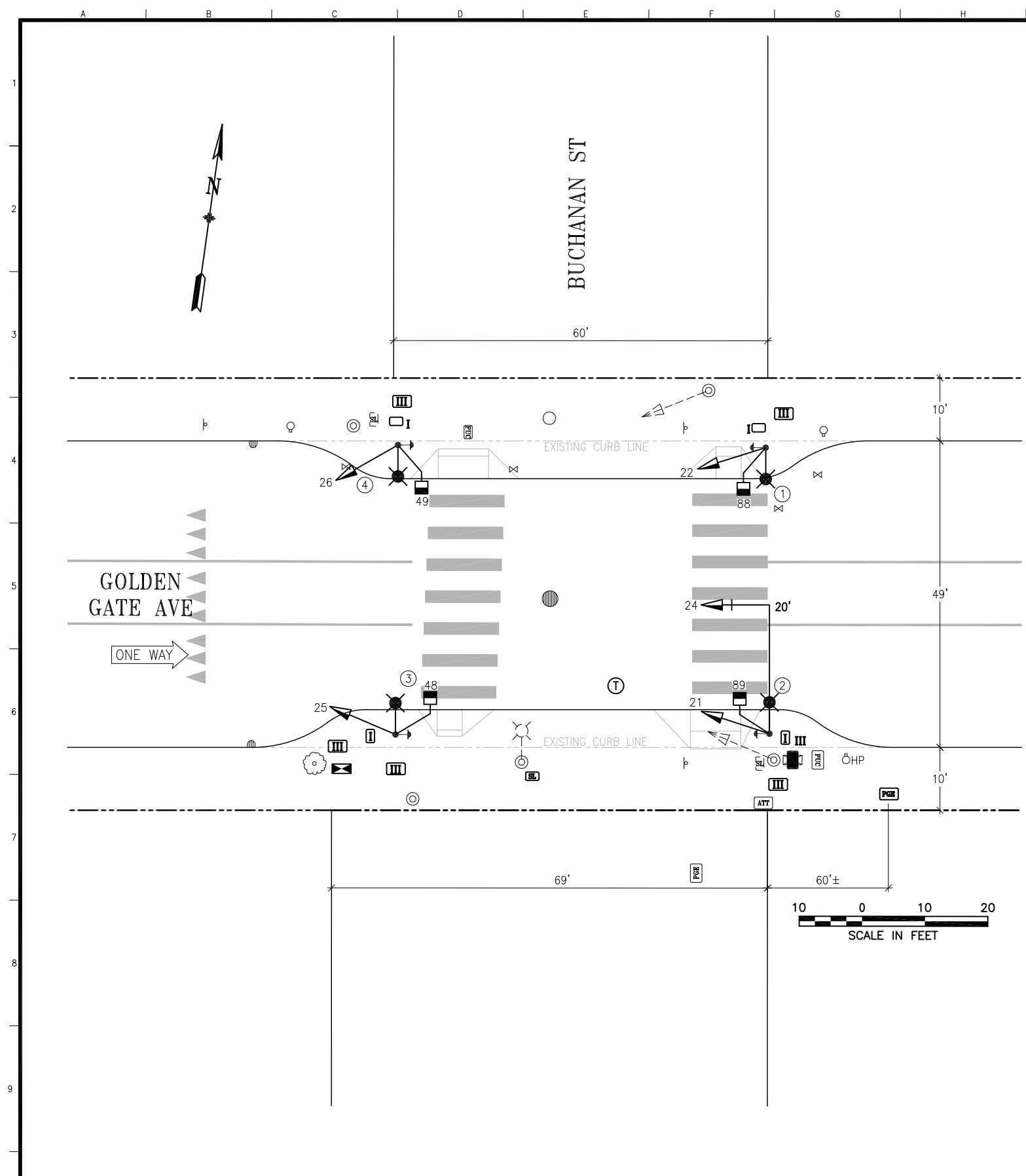

PROPOSED SIGNAL

POLE No.	TYPE OF POLE	LUMINAIRE TYPE	VEHICLE SIGNAL					PEDESTRIAN SIGNAL			REMARKS
			No.	TYPE	MOUNTING	VISORS	LOUVERS/BP	No.	TYPE	MOUNTING	
①	STEEL SL 28.5' w/ 6' LA		22	3S12"	SV-1-T	T		88	1S-COUNT	SP-1	APS-2W
②	17-2-100 w/ 20' MA & 6' LA		21 24	3S12" 3S12"	SV-1-T MAC	T T	BP	89	1S-COUNT	SP-1	APS-2W
③	STEEL SL 28.5' w/ 6' LA		25	3S12"	SV-1-T	T		48	1S-COUNT	SP-1	APS-2W
④	STEEL SL 28.5' w/ 6' LA		26	3S12"	SV-1-T	T		49	1S-COUNT	SP-1	APS-2W

SHEET NOTES:

** PROPOSED BULBS
LEGISLATED WITH
GOLDEN GATE-
LAGUNA PAVING
PROJECT (LIVABLE
STREETS)

PHASE DIAGRAM

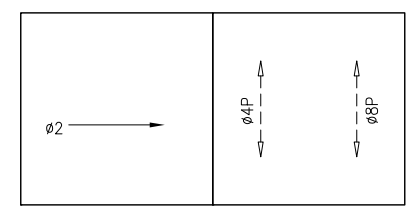

60% DESIGN

NO.	DATE	DESCRIPTION	BY	APP.
TABLE OF REVISIONS				
THIS DRAWING WAS LAST MODIFIED: 10/23/20 17:36, BY: ELuu				

REFERENCE INFORMATION
& FILE NO. OF SURVEYS



DESIGN & ENGINEERING
PUBLIC WORKS
CITY & COUNTY OF SAN FRANCISCO
30 VAN NESS AVENUE, 5TH FLOOR
SAN FRANCISCO, CA 94102 - 6028

Section Mgr: _____ Date: _____
Deputy Division Mgr: _____
Division Mgr: PATRICK RIVERA

DESIGNED: DATE: EL 06/2020
DRAWN: DATE: EL 06/2020
CHECKED: DATE: GD 06/2020



SCALE:
AS SHOWN
SHEET OF SHEETS
XX OF XX

WESTERN ADDITION AREA
TRAFFIC SIGNAL WORK
BUCHANAN STREET AND GOLDEN GATE AVENUE
TRAFFIC SIGNAL WORK
POLE AND EQUIPMENT SCHEDULE

CONTRACT NO. ##
DRAWING NO. E-26.0
FILE NO. XXXXX
REV. NO. XX

Drawing Path: T:\E-FILES\Special Projects & Street Use\Signal\ACAD\Design\Western Addition Signal Project\1 Design\ACAD\LEL_TBC
 Plot Time: Mon, 26 Oct 2020 - 10:31am
 Model Units: Undefined
 Model Units: Undefined

PROPOSED TIMING

Buchanan and Golden Gate		DESCRIPTION: Activate new signal (Western Addition).										
CHANGE: XX		NOTES:					Page 1 of 2					
CNN #: 6269000		PHASE	STREET	EmerFlash	ProgFlash	Controller: 2070		Cabinet: MSF-ATC				
ENGINEER: E. Luu		2	Golden Gate EB	R	R	Oper. Date:		System: Western Addition				
Revision date: XXX						Master:		TBC-GPS to Divisadero/Golden Gate				
Programmed by:												
Installed by:												
Date Completed:												

Buchanan and Golden Gate

Actuation
 Transit Priority
 Preemption

Steady Demand Sequence

X = YES	-- = NO	S	M	T	W	T	F	S	CYCLE	SPLIT	OFFSET	FLASH
06:00 to 10:00		--	X	X	X	X	X	--	2	1	2	--
14:00 to 21:00		--	X	X	X	X	X	--	3	1	3	--
02:00 to 06:00		--	X	X	X	X	X	--	--	--	--	X
03:00 to 06:00		X	--	--	--	--	--	X	--	--	--	X
ALL OTHER TIMES		X	X	X	X	X	X	X	1	1	1	--

STREET	PHASE	1	2	3	4	5	6	7	8	9	10	11	12	13	14	15
Golden Gate EB	2	G	Y				R									
Peds Xing Golden Gate WS	4P			RH		FRH		RH								
Peds Xing Golden Gate ES	8P			RH		FRH		RH								

ws3.0

CSO	CYCLE (seconds)	OFFSET (seconds)	SIGNAL INTERVALS (seconds)														
			1	2	3	4	5	6	7	8	9	10	11	12	13	14	15
111	70.0	20	45.5	4.0	1.5	7.0	8.0	4.0									
212	70.0	20	45.5	4.0	1.5	7.0	8.0	4.0									
313	70.0	20	45.5	4.0	1.5	7.0	8.0	4.0									

CHANGE

XX

TransBASE Internal Dashboard

BUCHANAN / GOLDEN GATE COLLISIONS

Geographic Extent: GOLDEN GATE AVE from WEBSTER ST to LAGUNA ST (0.36 miles/1903.24 feet)

Spatial Intersect: SFMTA Midblock (> 20ft or >150ft if Rear End)

Data Range: 07/01/2015 to 06/30/2020

Pull Date: 10/21/2020

Collision/Party/Victim Table

Showing 1 to 2 of 2 entries

Count of Fatal Collisions: 0

Count of Non-Fatal Injury Collisions: 2

Total Count of Fatal/Non-Fatal Injury Collisions: 2

Case ID	Collision Date	Collision Time	Day of Week	Primary Road	Secondary Road	Distance	Direction	Party 1 Type	Party 1 Direction of Travel	Party 1 Movement Preceeding Crash	Party 2 Type	Party 2 Direction of Travel	Party 2 Movement Preceeding Crash	Vehicle Code Violation	Highest Degree of Injury	Type of Collision	Motor Vehicle Involved With	Weather	Lighting		
190259422	04/12/2019	07:45	Friday	GOLDEN GATE AVE	LAGUNA ST	450	West	Driver	East	Proceeding Straight	Driver	Not Stated	Parked	CVC 22350	Injury (Severe)	Rear End	Parked Motor Vehicle	Clear	Daylight		
																				No report	
170133692	02/16/2017	09:05	Thursday	GOLDEN GATE AVE	WEBSTER ST	415	East	Driver	East	Proceeding Straight	Driver	East	Slowing/ Stopping	CVC 21703	Injury (Complaint of Pain)	Rear End	Other Motor Vehicle	Clear	Daylight		
																					Speeding