

## SFMTA - TASC SUMMARY SHEET

<b>PreStaff_Date:</b> 4/14/2026 <b>Requested_by:</b> SFMTA <b>Handled:</b> Laura Stonehill (646-4320) <b>Section Head :</b> M. Sallaberry <i>MS</i>	<input type="checkbox"/> <b>Public Hearing Consent</b> <input checked="" type="checkbox"/> <b>Public Hearing Regular</b> <input type="checkbox"/> <b>Informational / Other</b> <small>PH - Regular</small>	<b>No objections:</b> _____ <b>Item Held:</b> _____ <b>Other:</b> _____
<b>Location:</b> Polk Street at Clay Street		
<b>Subject:</b> Bikeshare station		
<b>PROPOSAL / REQUEST:</b> ESTABLISH – NO STOPPING, EXCEPT BICYCLES ESTABLISH – BIKESHARE STATION Polk Street, west side, from Clay Street to 24 feet northerly (in existing red zone) Clay Street, north side, from Polk Street to 26 feet westerly (in existing red zone)  ESTABLISH - METERED YELLOW ZONE, COMMERCIAL LOADING, 30-MINUTE LIMIT, 8 AM TO 6 PM, MONDAY THROUGH SATURDAY Polk Street, west side, from 24 feet to 44 feet north of Clay Street (converting general meter stall 1705) (Supervisor District 3)  Proposal to install a bikeshare station in two segments in the red zones at Polk and Clay Street.  Laura Stonehill, laura.stonehill@sfmta.com		
<b>BACKGROUND INFORMATION / COMMENTS</b> Stations with bicycles are 6.5 feet wide and 4 feet tall with a 7.8 feet tall map panel away from the intersection. Stations are solar powered via solar panels on each dock. Station segments of fewer than 8 docks are bolted to the street. No excavation is necessary.  - bike lane on Polk - Muni on Polk.  E23-2 12-dock station		
<b>HEARING NOTIFICATION AND PROCESSING NOTES:</b>	<b>ENVIRONMENTAL CLEARANCE BY:</b> <input type="checkbox"/> SFMTA <input checked="" type="checkbox"/> Attached <input type="checkbox"/> Pending	
<b>CHECK IF PREPARING SEPARATE SFMTA BOARD CALENDAR ITEM FOR PROPOSAL:</b> <input type="checkbox"/>		



= PLAN REFERENCE POINT

**SITE LOCATION**  
NOT TO SCALE

Stand Pipe		Parking Meters	
Fire Hydrants (High Pressure)		Tree With Grate/Well	
Fire Hydrants (Low Pressure)		Proposed Red Curb	
Street Light with Arm		Proposed Blue Curb	
Street Light		Proposed Yellow Curb	
Utility Pole		Proposed Green Curb	
Signal Pole		Proposed White Curb	

**ABBREVIATIONS**

BS = BUS SHELTER	TC = TRASH CAN
BR = BIKE RACK	TYP. = TYPICAL
CC = TRAFFIC SIGNAL CONTROLLER CABINET	UC = UTILITY CABINET
DI = DRAINAGE INLET	V = UTILITY VALVE
DW = DRIVEWAY	UV = UTILITY VAULT
LF = LINEAR FEET	R/C = EXISTING RED CURB
MB = MAIL BOX	B/C = EXISTING BLUE CURB
MH = MANHOLE	Y/C = EXISTING YELLOW CURB
NS = NEWSPAPER STAND	G/C = EXISTING GREEN CURB
PB = PULL BOX	W/C = EXISTING WHITE CURB
M/C = MOTORCYCLE	

GIVEN DIMENSIONS TAKE PRECEDENCE OVER SCALED MEASUREMENTS

**N**

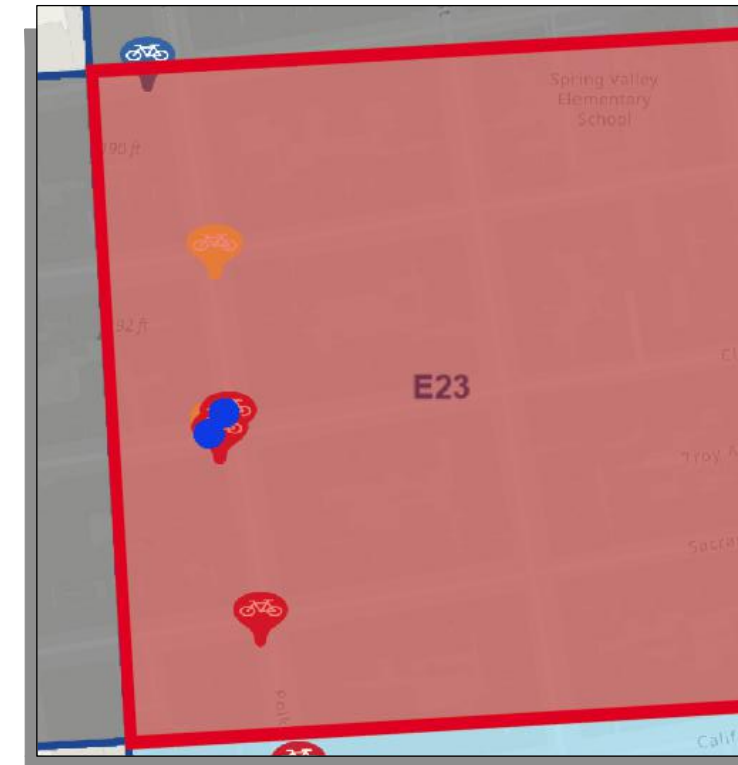

**VICINITY MAP**  
NOT TO SCALE

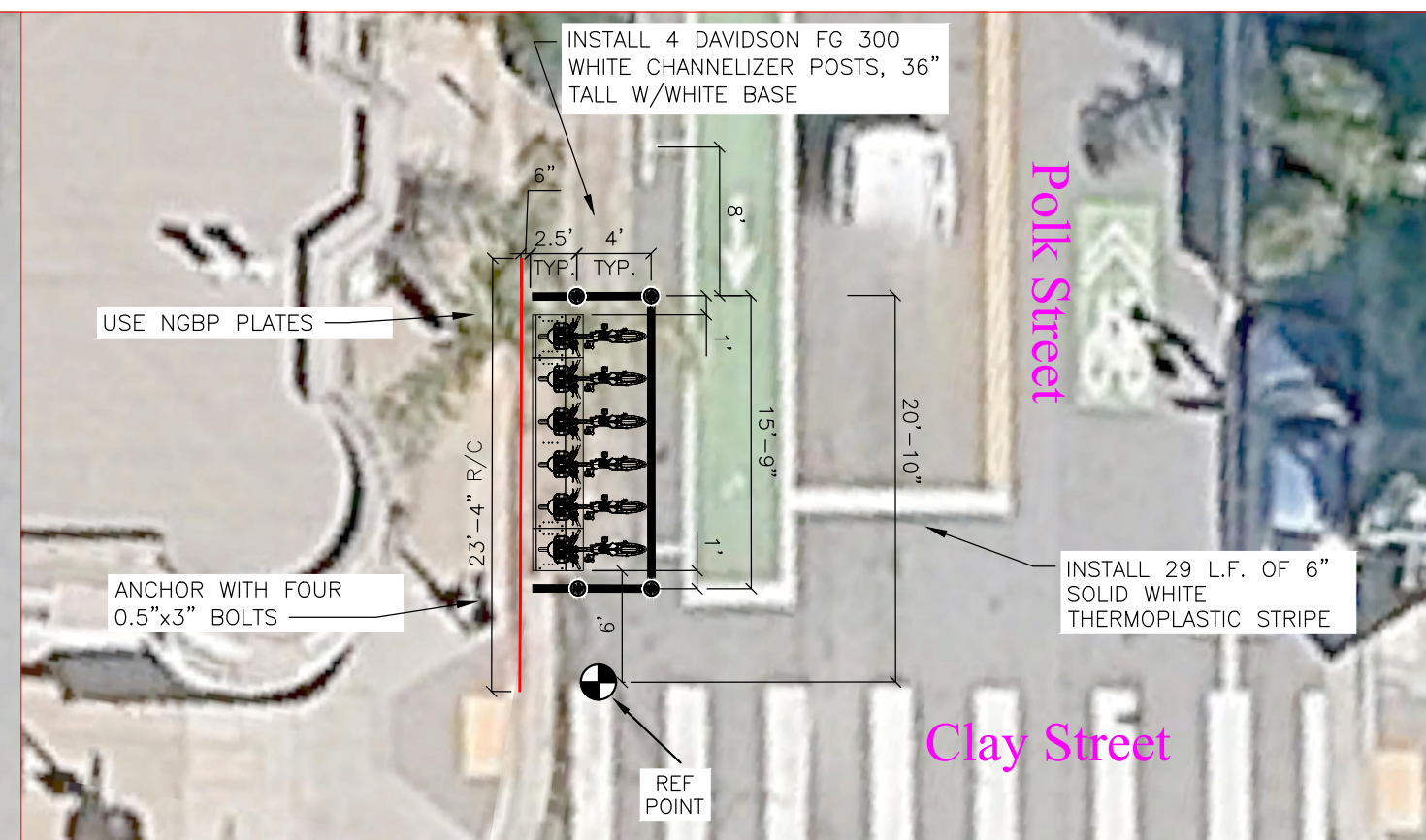
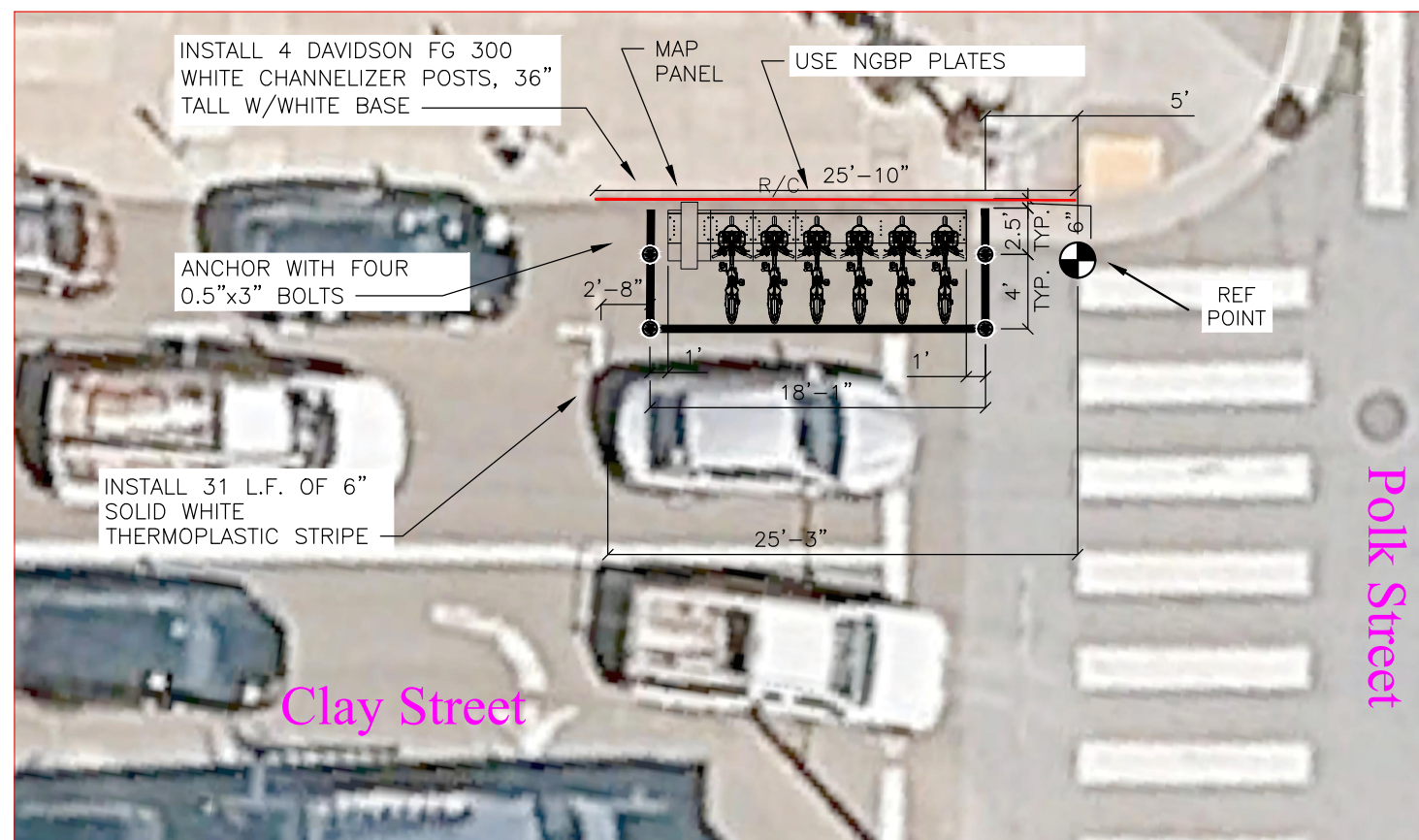

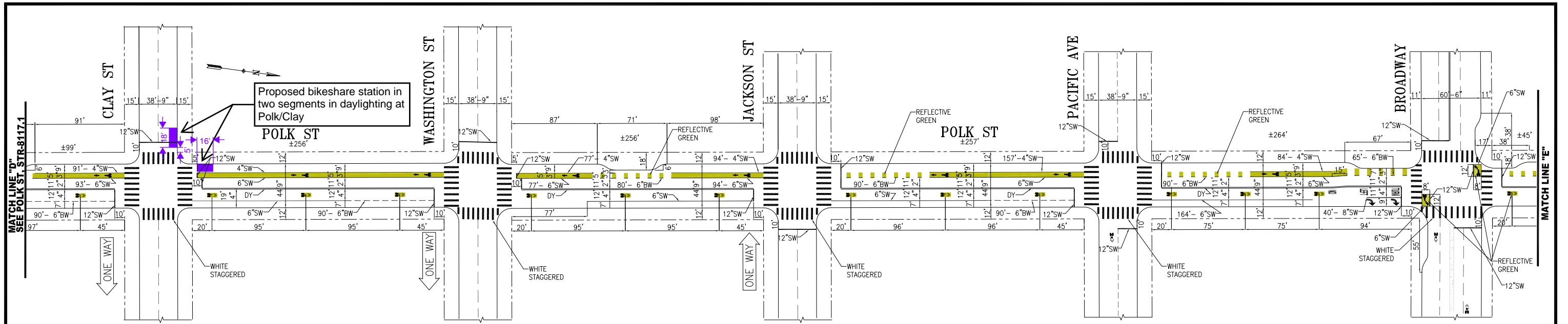

- GENERAL NOTE:
1. PAVEMENT COLOR IN BIKE LANE IS NON-REFLECTIVE BIKE LANE GREEN UNLESS OTHERWISE NOTED.
  2. SHARED ROADWAY MARKINGS SHALL BE 13' FROM CURB FACE TO CENTER OF MARKING UNLESS OTHERWISE NOTED

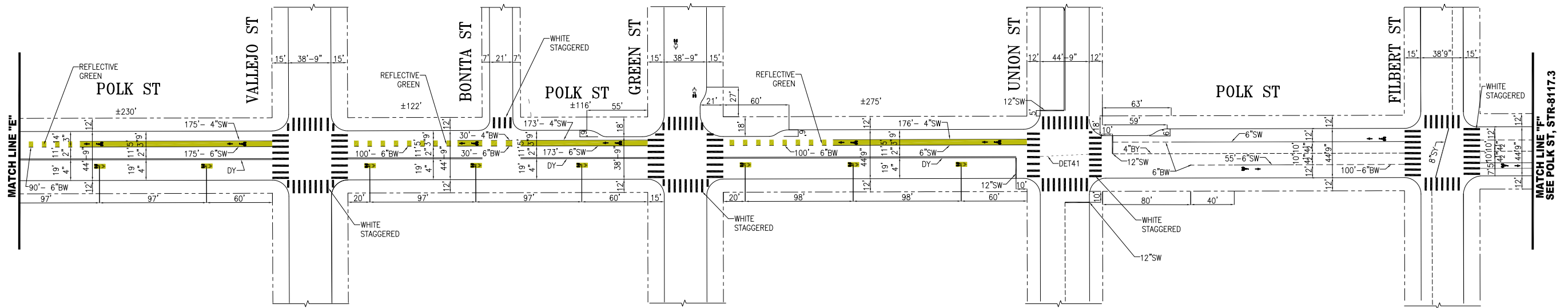

NO.	DATE	DESCRIPTION	BY	APP
1	04/27/21	PER FIELD UPDATE: SHIFTED DY @ WEST OF UNION	S.SHARIATI	C.BECK
2	12/01/18	ADDED GREEN SHARROWS AND 6" BW LINE, GREEN BIKE LANE SB. ADDED ADVANCE LIMIT LINES AT CLAY.	E.ROBINSON	M.SALLABERRY
3	08/01/18	ADJUST STRIPING AT BONITA PER FIELD	L.YEE	C.HUI
4	06/06/18	WHITE STAGGERED CONTINENTALS AT FILBERT	L.YEE	C.HUI

TABLE OF REVISIONS  
CHECK WITH TRACING TO SEE IF YOU HAVE LATEST REVISION



SUPERCEDES STR-7609.1, REV2	APPROVED GERALDINE DE LEON FOR MIKE SALLABERRY 7/28/2015	SCALE: 1" = 50'
DRAWN: M.LUC	DATE: 06/2015	SENIOR ENGINEER
CHECKED: G.DeLEON	DATE: 07/2015	RICARDO OLEA 7/28/2015 CITY TRAFFIC ENGINEER
SHEET/SHEETS: 3 OF 4		

CONTRACT NO.  
DRAWING NO.  
STR-8117.2  
FILE NO.  
REV. NO.  
7

TRAFFIC STRIPING  
POLK STREET  
SACRAMENTO STREET TO FILBERT STREET

FILE NAME  
DATE: --/--/---

4" Yellow & Stripe - Franklin St to Gough St.  
Continue 4" Stripes to Franklin St.

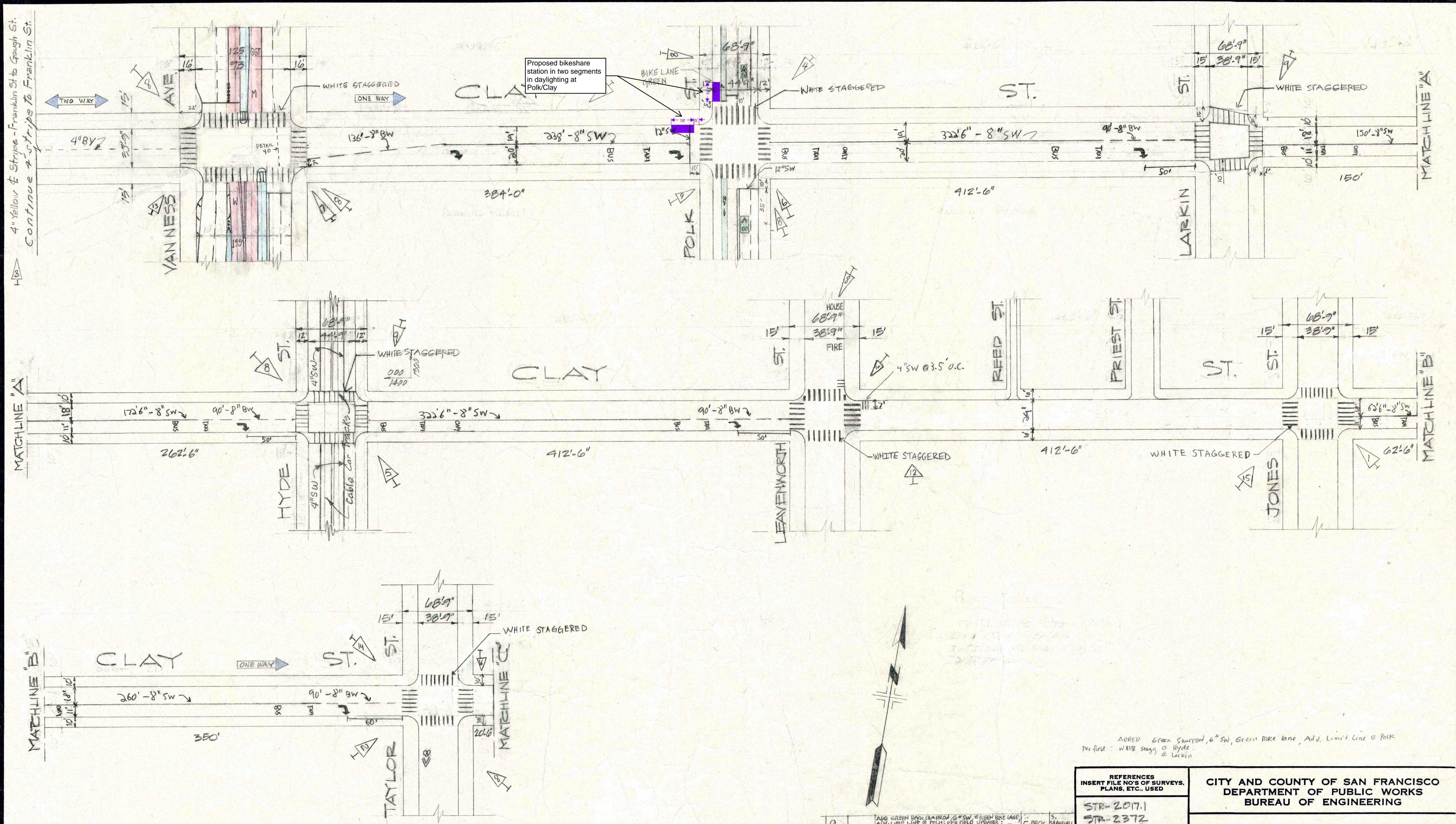

Proposed bikeshare station in two segments in daylighting at Polk/Clay

NO.	DATE	DESCRIPTION	AUTHOR	BY
15	08-25-25	ADDED WHITE CONTIS @ JONES	JWONG/A/AM	
14		ADDED WHITE CONTIS @ TAYLOR	S. QIN/P. TAI	
13	3-28-22	NEW STRIPING, BULBS, TRANSIT-ONLY LANE @ VAN NESS AS PART OF UBERT PROJECT	CHINE/CHUI	
12	05-14-23	ADDED WHITE STAG. CONTIS @ LEAVENWORTH	C. LEE/A. LY	
11	6-21-21	ADDED BTD + RFA VAN NESS TO TAYLOR	S.A. OLA	
10	5-20-21	PER FIELD: ADDED DMC AT LEAVENWORTH	S.A. OLA	

NO.	DATE	DESCRIPTION	AUTHOR	BY
9		ADD GREEN BACKLAP PAV. @ SW & GREEN BIKE LANE	C. OBECK	S. SAHAWI
8	9-23-18	ADD LIMIT LINE @ POLK, PER FIELD NOTES	E. ROBINSON	CHARRATE
7	02-24-18	ADDED WHITE CONTIS @ VAN NESS	MS	DCAR
6	5-21-18	ADDED SB BIKE LANE @ POLK	MS	PS
5	3-12-18	PER FC, ADDED XWAYS @ HYDE	GD	CB
4	07/20/15	ADDED WHITE STAG CONTINENTAL @ POLK	GD	PS
3	5-16-17	PAINT E-W YELLOW - Gough St to Franklin St	MS	RDE
2	11/21/15	ADDED 4" YELLOW STRIPES TO FRANKLIN ST	MS	L.S.
1	12-3-11	ADDED X/W ON CLAY & JONES	MS	GDR

TABLE OF CHANGES  
CAUTION: CHECK WITH TRACING TO SEE IF YOU HAVE LATEST REVISION

REFERENCES  
INSERT FILE NO'S OF SURVEYS, PLANS, ETC., USED

STR-2017.1  
STR-2372  
STR-1425

CITY AND COUNTY OF SAN FRANCISCO  
DEPARTMENT OF PUBLIC WORKS  
BUREAU OF ENGINEERING

**CLAY STREET**  
VANNESS AVE TO THE EMPARADERO

TRAFFIC STRIPING

DESIGNED BY: \_\_\_\_\_ DATE: \_\_\_\_\_  
DRAWN BY: \_\_\_\_\_ DATE: \_\_\_\_\_  
CHECKED BY: \_\_\_\_\_ DATE: \_\_\_\_\_

APPROVED: \_\_\_\_\_ DATE: \_\_\_\_\_  
SECTION ENG. \_\_\_\_\_ DATE: \_\_\_\_\_  
DIVISION ENG. \_\_\_\_\_ DATE: \_\_\_\_\_

SCALE 1" = 50'

SHEET 1 OF 3 SHEETS

FILE STR-2668  
CHANGE 15

ADDED Green Painted, 6" SW, Green Bike Lane, Adj. Limit Line @ Polk  
Per Field: White Stagg @ Hyde

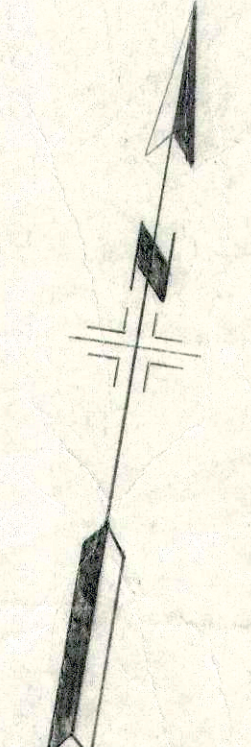

BY APP.

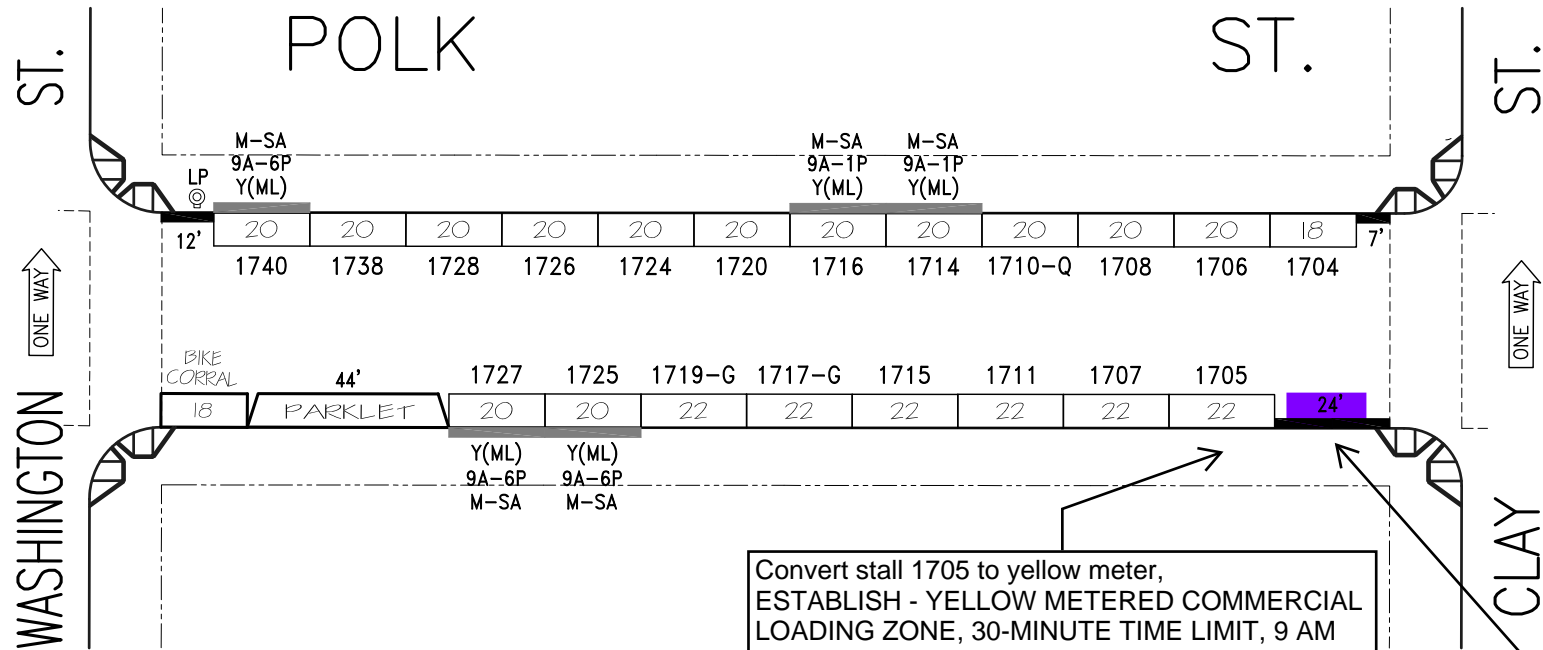

Convert stall 1705 to yellow meter,  
ESTABLISH - YELLOW METERED COMMERCIAL  
LOADING ZONE, 30-MINUTE TIME LIMIT, 9 AM  
TO 6 PM, DAILY

Proposed bikeshare  
station segment

NO.	REVISION DESCRIPTION	BY	DATE	DIR/RES	5	Updated per field	JB	5/22/18
8	Establish 15-Min.Green#1710-E/S	JB	3/21/25	6823	6	Rescind T/A, 7A-10A, E/S	JB	7/8/21 6413
					7	Est.30Min-Green#1717,19(MOS#1701)	JB	12/8/23 6676(AB413)

**SAN FRANCISCO MUNICIPAL TRANSPORTATION AGENCY**  
 CITY AND COUNTY OF SAN FRANCISCO  
 PARKING METER SPACES

SIDE	TOW-AWAY		METER CT.		GENERAL				LOADING			METERED SPACES						TOTAL
	AM	PM	SS	MS	GMP	MC	TIMES	DAYS	ML	MTL	6-W	15 MIN	30 MIN	1 HR	2 HR	10 HR		
ODD			8		6		9A-6P	M-SA	2				4		4		8	
EVEN			12		9		9A-6P	M-SA	3			1	3		8		12	

**POLK ST. (POL, 612)**  
**(1700) BLOCK**  
 Meters #612-17XXY  
**CLAY ST. TO WASHINGTON ST.**

SCALE: **1" = 40'**      DATE: **2/24/18**      BY: **JB**

**AREA 3**

Revised: 02/24/18 14:19  
 File: 171719\_MOS\_Parking\_Meter\_Spaces\_Plan\_Sheet\_01.dwg

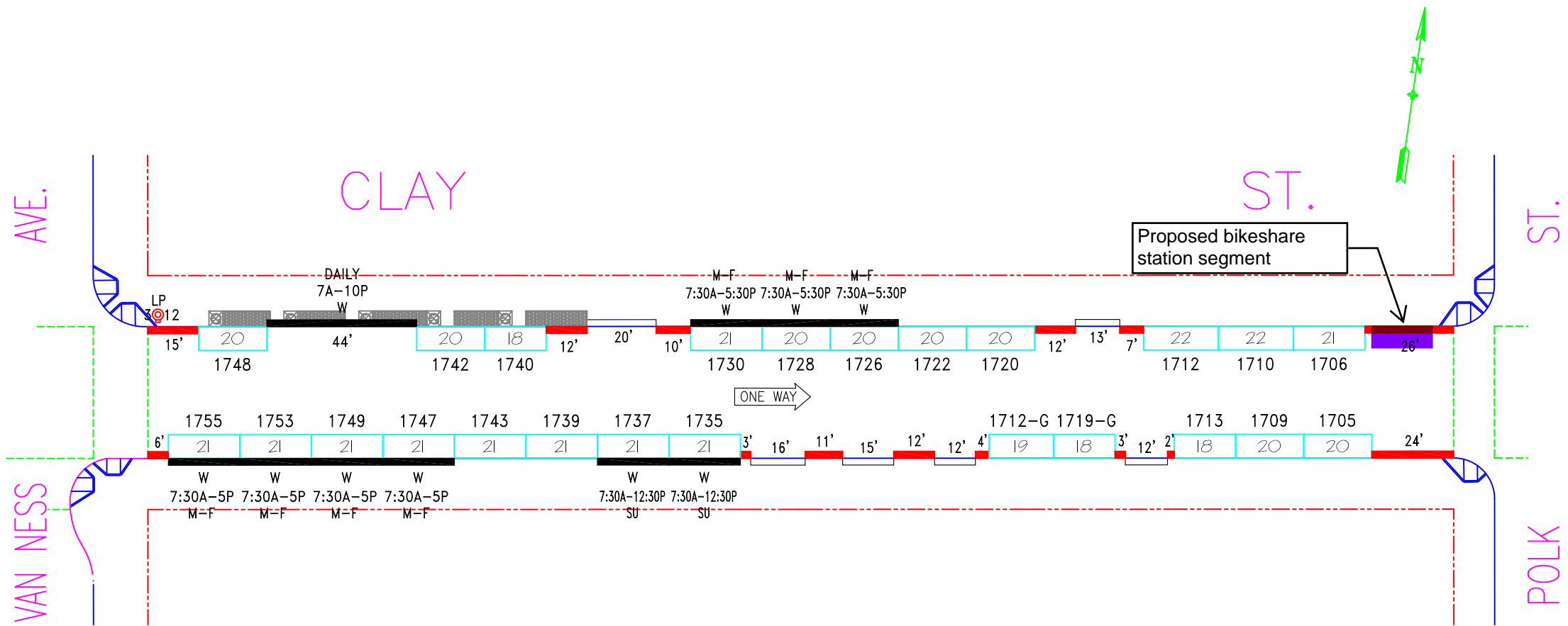

NO.	REVISION DESCRIPTION	BY	DATE	DIR/RES	11	12	13	14	15	16	17	18	19	20	21	22	23	24
					Daylighting: Add 26' RZ, MOS#1704-N/S													
9	Est. New PT-PLZ on #1735-55, S/S	JB	8/10/16	5601	Revoke PT-PLZ on #1739,1743-S/S													6574
10	Establish Red zone, MOS#1701-S/S	JB	10/12/17	16-026														



**SAN FRANCISCO MUNICIPAL TRANSPORTATION AGENCY**  
**CITY AND COUNTY OF SAN FRANCISCO**  
 PARKING METER SPACES

SIDE	TOW-AWAY		METER CT.		GENERAL				LOADING		METERED SPACES							TOTAL
	AM	PM	SS	MS	GMP	MC	TIMES	DAYS	ML	MTL	6-W	15 MIN	30 MIN	1 HR	2 HR	10 HR		
ODD			13		13		9A-6P	M-SA					2		11		13	
EVEN			11		11		9A-6P	M-SA							11		11	

**CLAY ST. (CLA, 359)**  
**(1700) BLOCK**  
 Meters #359-17XXY  
**POLK ST. TO VAN NESS AVE.**

SCALE: **1"=40'**      DATE: **3/17/14**      BY: **JB**

**AREA**  
**3**

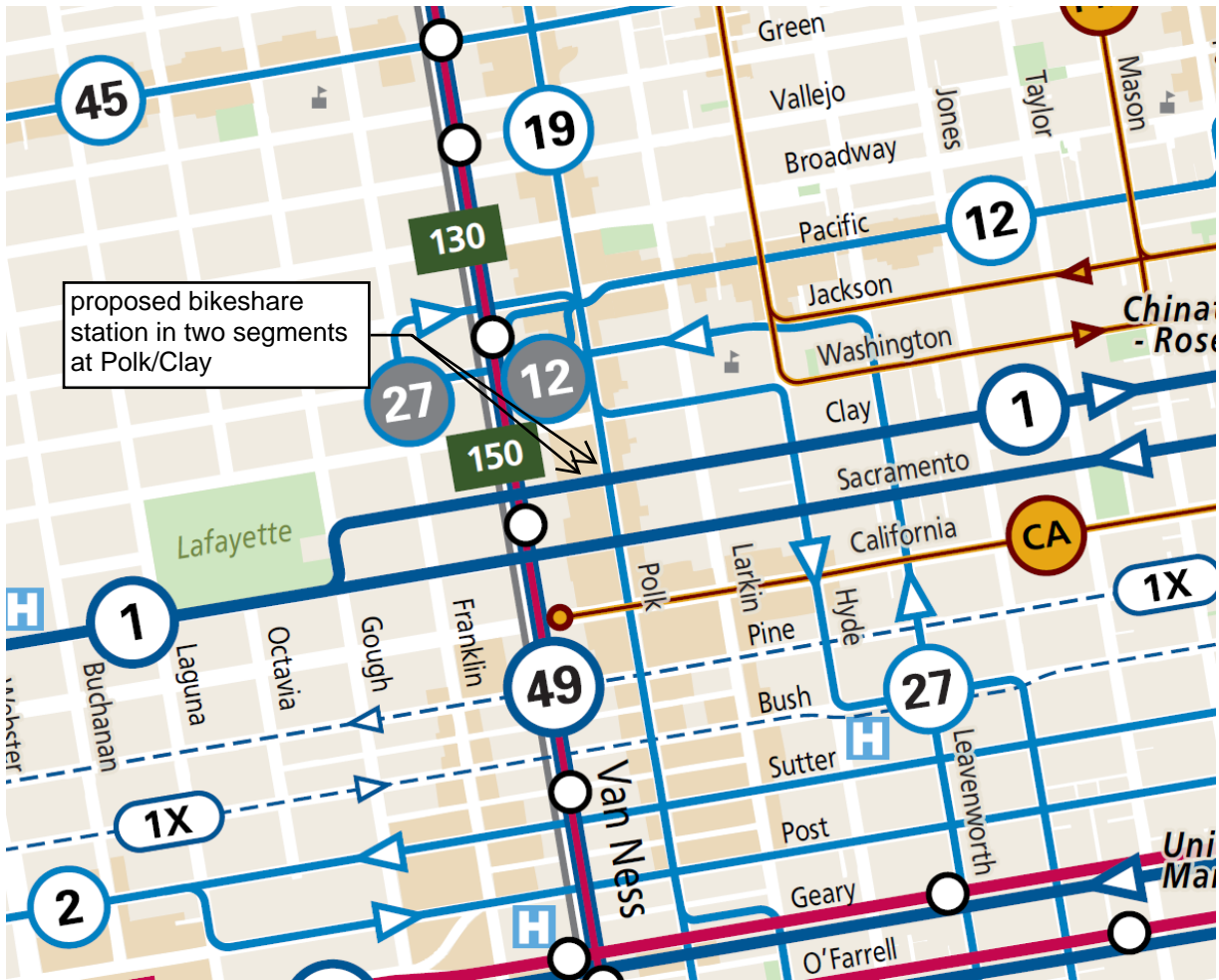

Bike map

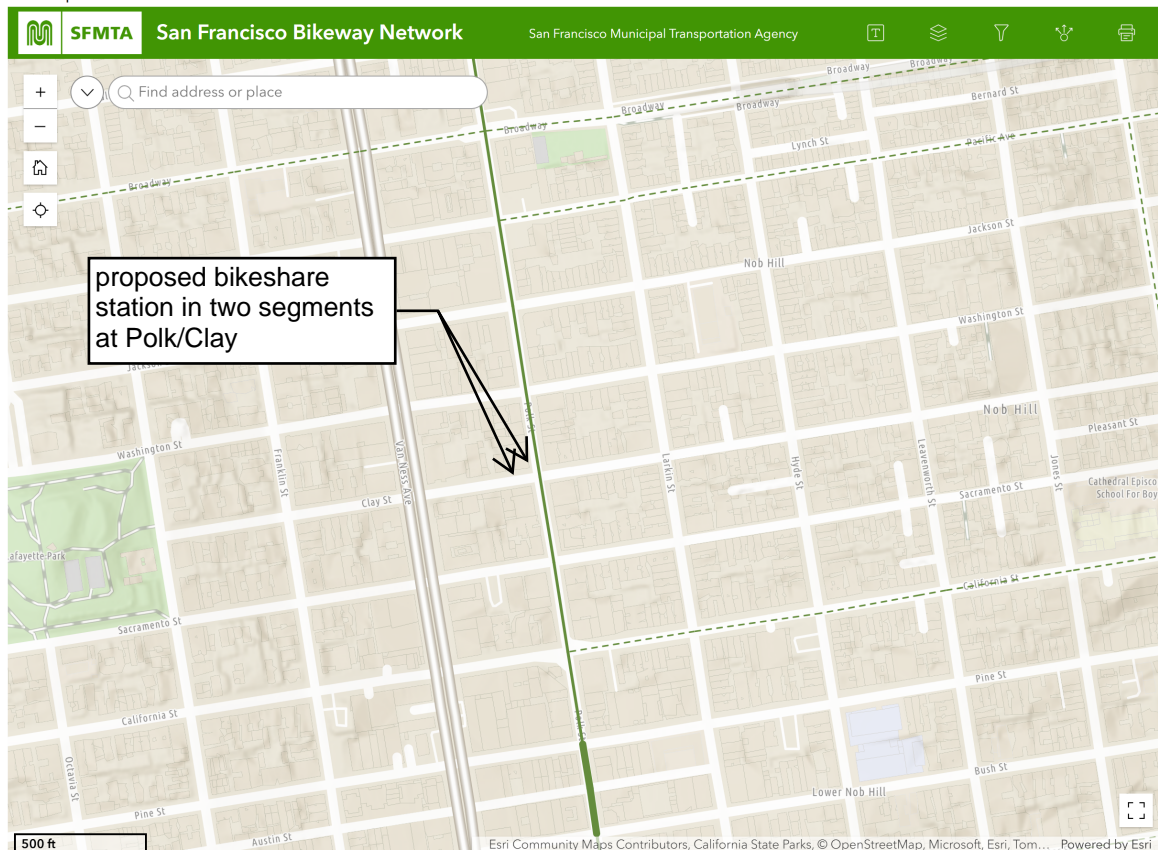

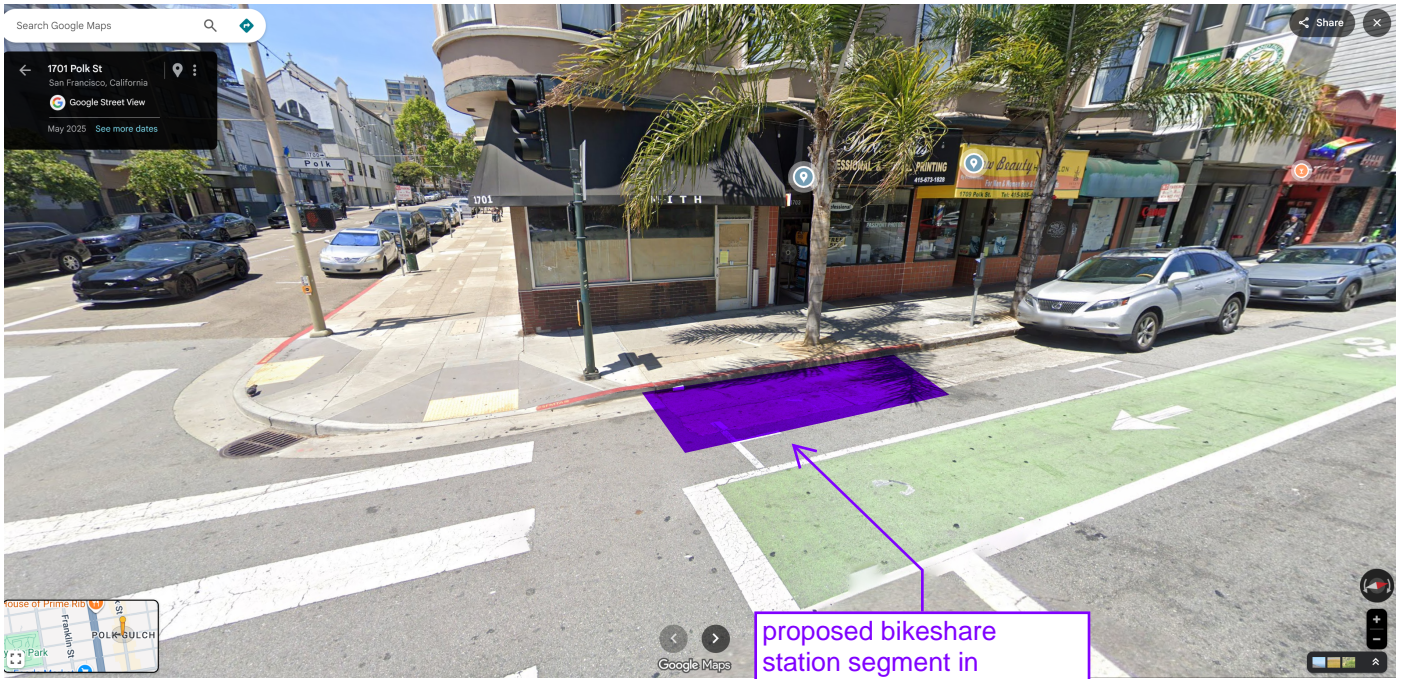

proposed bikeshare station segment in daylighting on the west side of Polk, north of Clay

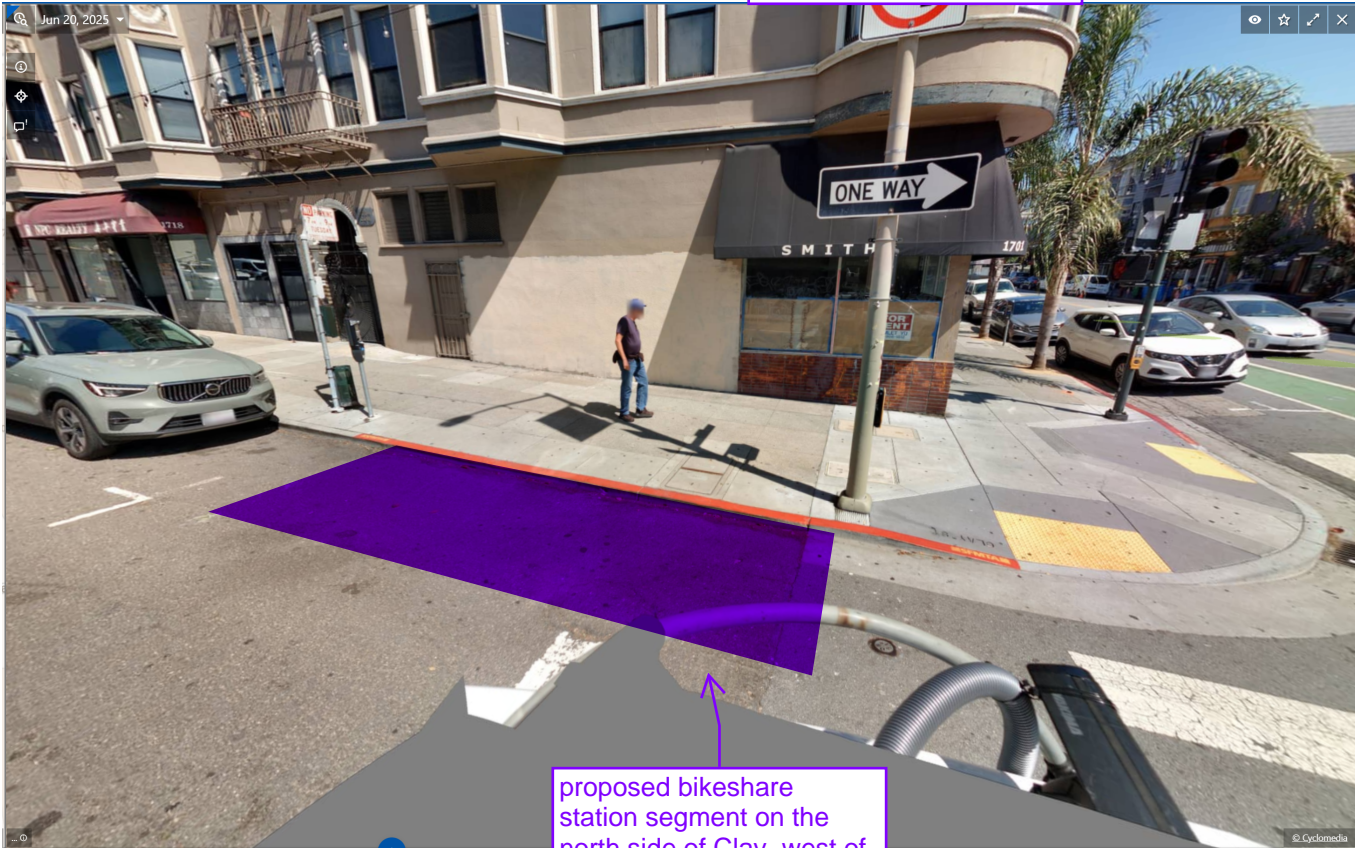

proposed bikeshare station segment on the north side of Clay, west of Polk



Existing Bay Wheels station map  
existing stations in green  
proposed stations in yellow

proposed bikeshare station in two parts at Polk/Clay

The image shows a Google Maps interface with a sidebar on the left. The sidebar is titled "Laura's station ideas" and contains several layers. The "2026 Station Planning Proposals" layer is selected and highlighted in blue. This layer shows 72 items, represented by yellow pins. One yellow pin is located at the intersection of Polk St and Clay St, with a callout box pointing to it that says "proposed bikeshare station in two parts at Polk/Clay". Other layers include "Existing stations" (360 items, green pins), "Proposed Bike Corrals", "Heavy Station Proposals in Daylit...", "SF\_BOS\_FinalMap", "Bike rental companies", and "Melgar Rejected". The map itself shows a grid of streets in San Francisco, including Broadway, Polk St, Clay St, and Van Ness Ave. Various landmarks and businesses are labeled on the map.



# SAN FRANCISCO PLANNING DEPARTMENT

## Notice of Exemption

1650 Mission St.  
Suite 400  
San Francisco,  
CA 94103-2479

Reception:  
415.558.6378

Fax:  
415.558.6409

Planning  
Information:  
415.558.6377

DEC 22 2015  
POSTED TO

*Approval Date:* December 18, 2015  
*Case No.:* 2015-005492ENV, SFMTA Bay Area Bicycle Share Project  
*Project Title:* Citywide in San Francisco, primarily within the public right-of-way  
*Zoning:* Not applicable, primarily in the public right of way  
*Block/Lot:* Not applicable, primarily in the public right of way  
*Lot Size:* Not applicable, primarily in the public right of way  
*Lead Agency:* San Francisco Planning Department  
*Project Sponsor:* Heath Maddox, San Francisco Municipal Transportation Agency  
 415-701-4789  
 heath.maddox@sfmta.com  
*Staff Contact:* Debra Dwyer  
 415-575-9031  
 debra.dwyer@sfgov.org

2015-0600

ENDORSED  
FILED  
SAN FRANCISCO County Clerk

DEC 22, 2015

by: FANNY WONG  
Deputy County Clerk

To: County Clerk, City and County of San Francisco  
City Hall Room 168  
1 Dr. Carlton B. Goodlett Place  
San Francisco, CA 94102

Pursuant to the California Environmental Quality Act (CEQA), the Guidelines of the Secretary for Resources, and San Francisco requirements, this Notice of Exemption is transmitted to you for filing. At the end of the posting period, please return this Notice to the Staff Contact with a notation of the period it was posted.

Attached fee: \$60 filing fee

### PROJECT DESCRIPTION:

The San Francisco Municipal Transportation Agency (SFMTA) proposes to implement a city-wide bicycle sharing system in San Francisco as part of the regional Bay Area Bicycle Share (BABS) system described in detail below. The current regional bicycle share system in San Francisco is a pilot project managed by the Bay Area Air Quality Management District (BAAQMD). The regional BABS system will transfer to the Metropolitan Transportation Commission (MTC) for program oversight at the end of 2015. As part of a BABS pilot project initiated on August 29, 2013, the system operator installed approximately 35 bicycle share stations with input from the SFMTA, comprising 350 bicycles within the public right-of-way, located generally in the northeast section of the City. The proposed project would maintain and upgrade the existing 35 pilot bicycle share stations, and expand the BABS system within San Francisco to comprise a total of approximately 450 stations and 4,500 bicycles across the City and County of San Francisco (San Francisco).

**DETERMINATION:**

The City and County of San Francisco decided to carry out or approve the project on December 18, 2015. The San Francisco Board of Supervisors (BOS) approved a coordination agreement with the Metropolitan Transportation Commission (MTC), other local partners in the East and South Bay, and the bicycle share operator to carry out the Bay Area Bicycle Share Program, which would be overseen in San Francisco by the San Francisco Municipal Transportation Agency (SFMTA) on December 8, 2015. The agreement was provided to Mayor Lee for his signature and becomes effective upon signing or when ten days have passed. A copy of documents related to this action may be examined at the San Francisco Board of Supervisors, City Hall, 1 Carlton B. Goodlett Place Room 244, San Francisco, CA, 94102 in File Number 151144.

- 1. An Exemption from Environmental Review has been prepared pursuant to the provisions of CEQA under:

- Ministerial (Sec. 21080(b)(1); 15268)
- Declared Emergency (Sec. 21080(b)(3); 15269(a))
- Emergency Project (Sec. 21080(b)(4); 15269(b)(c))
- Categorical Exemption, Class 3, Section 15303
- Statutory Exemption, State code number: \_\_\_\_\_
- Community Plan Exemption (Sec. 21083.3; 15183)

- 2. This project in its approved form has been determined to be exempt from environmental review because it would result in the installation of up to 450 bicycle sharing stations throughout San Francisco, primarily within the public right-of-way and on some parcels. The proposed individual stations are portable, modular, and would be solar and battery powered, and would thus not involve excavation or utility connections. The bicycle sharing station equipment is small in scale and massing relative to surrounding buildings or sites. Bicycle facilities and infrastructure are common sights within the urban environment. There would be no potential for significant environmental impacts at either a project or cumulative level. Therefore, the proposed project would be exempt from environmental review under Class 3.

John Rahaim  
Planning Director

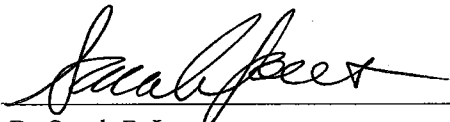
  
By Sarah B. Jones  
Environmental Review Officer

December 22, 2015  
Date

cc: Heath Maddox, SFMTA  
Interested parties