

SFMTA - TASC SUMMARY SHEET

PreStaff_Date: 7/19/2022 Requested_by: SFMTA Handled: Laura Stonehill 646-4320 Section Head : M. Sallaberry <i>MS</i>	<input type="checkbox"/> Public Hearing Consent <input checked="" type="checkbox"/> Public Hearing Regular <input type="checkbox"/> Informational / Other <small>PH - Regular</small>	No objections: _____ Item Held: _____ Other: _____
--	---	---

Location: Laguna Street at Grove Street

Subject: Bike Share Station

PROPOSAL / REQUEST:

ESTABLISH – NO STOPPING EXCEPT BICYCLES
ESTABLISH – BIKE SHARE STATION

Laguna Street, west side, from Grove Street to 86 feet northerly (Supervisor District 5)

Proposing to temporarily relocate a Bay Wheels bike share station from the parking lane on the south side of Fulton, east of Laguna to this location in the parking lane on the west side of Laguna, north of Grove, adjacent to 715/721 Laguna St. This temporary move is to accommodate electrical and paving work on Fulton St. which we expect to be complete by the end of the year.

Laura Stonehill, laura.stonehill@sfmta.com

BACKGROUND INFORMATION / COMMENTS

Temporary move of the existing station on the south side of Fulton, east of Laguna, to accommodate electrical work and then repaving. Station will be moved 7/12/22. Electrical work is expected to take 2-4 weeks, and repaving will follow in October/November.

No Muni
No bike facilities

Grid I21
31 docks

HEARING NOTIFICATION AND PROCESSING NOTES:

ENVIRONMENTAL CLEARANCE BY:

SFMTA Attached Pending

CHECK IF PREPARING SEPARATE SFMTA BOARD CALENDAR ITEM FOR PROPOSAL:



Stand Pipe
 Fire Hydrants (High Pressure)
 Fire Hydrants (Low Pressure)
 Street Light with Arm
 Street Light
 Utility Pole
 Signal Pole

Parking Meters
 Tree With Grate/Well
 Proposed Red Curb
 Proposed Blue Curb
 Proposed Yellow Curb
 Proposed Green Curb
 Proposed White Curb

PM
 R/C
 B/C
 Y/C
 G/C
 W/C

ABBREVIATIONS

BS = BUS SHELTER
 BR = BIKE RACK
 CC = TRAFFIC SIGNAL CONTROLLER CABINET
 DI = DRAINAGE INLET
 DW = DRIVEWAY
 LF = LINEAR FEET
 MB = MAIL BOX
 MH = MANHOLE
 NS = NEWSPAPER STAND
 PB = PULL BOX
 M/C = MOTORCYCLE

TC = TRASH CAN
 TYP. = TYPICAL
 UC = UTILITY CABINET
 V = UTILITY VALVE
 UV = UTILITY VAULT
 R/C = EXISTING RED CURB
 B/C = EXISTING BLUE CURB
 Y/C = EXISTING YELLOW CURB
 G/C = EXISTING GREEN CURB
 W/C = EXISTING WHITE CURB

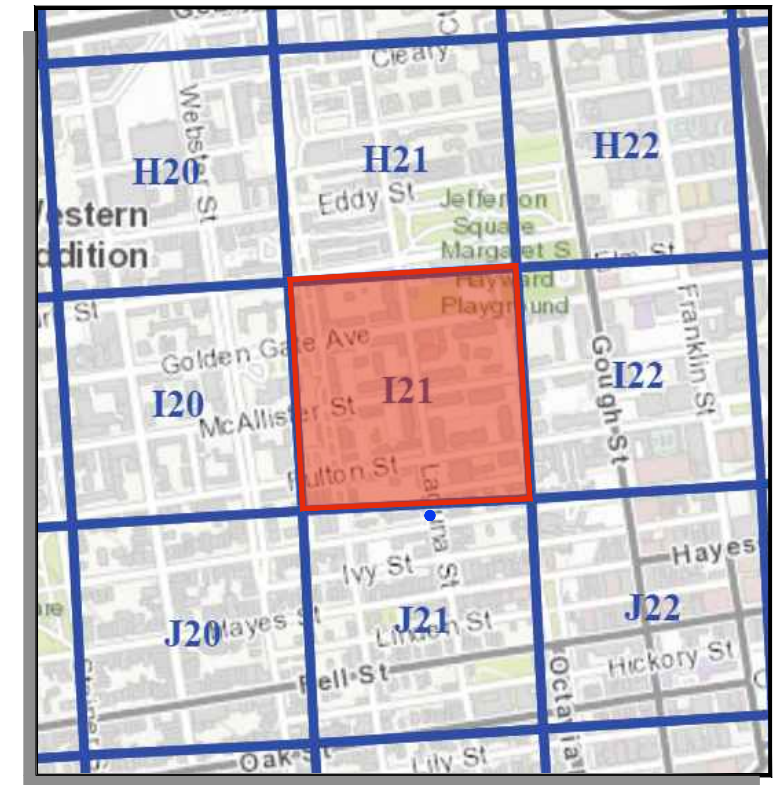

SITE NOTES

- ON-STREET SITE
- ADJACENT TO 715 LAGUNA ST
- UNMETERED PARKING

⊕ = PLAN REFERENCE POINT

SITE LOCATION
 NOT TO SCALE

Source: GrandView Services, MAY 2020

VICINITY MAP
 NOT TO SCALE

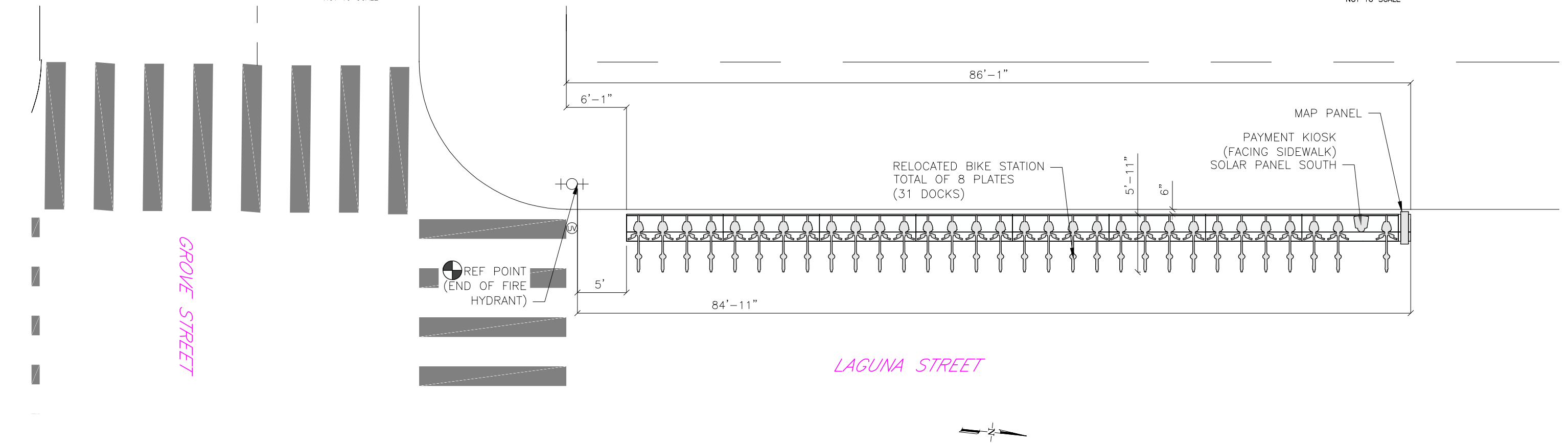

SITE PLAN

5 0 5 10
 GIVEN DIMENSIONS TAKE PRECEDENCE OVER SCALED MEASUREMENTS

Aerial Overlay prepared by Grandview Services, MAY 2020

REVISIONS		
NO.	DATE	DESCRIPTION



DRAWN BY: SI
 DESIGNED BY: SI
 CHECKED BY: CMV
 DATE: 05/20/20
 PROJECT NO:

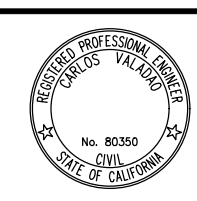

STATION TYPE:	Standard On-Street
STATION ID:	SF-I21
PLATES:	8
DOCKS:	31
KIOSKS:	1

Station Site and Plan
 SF-I21 (STATION MOVE)
 LAGUNA ST AT GROVE ST

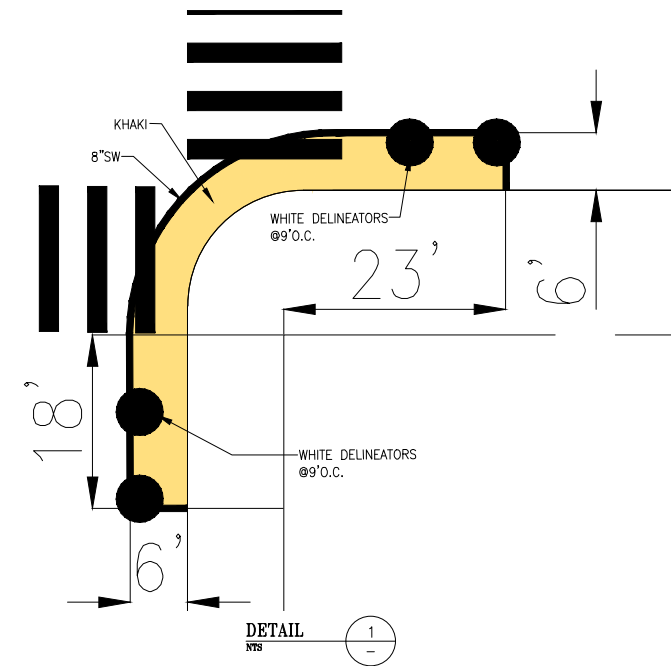
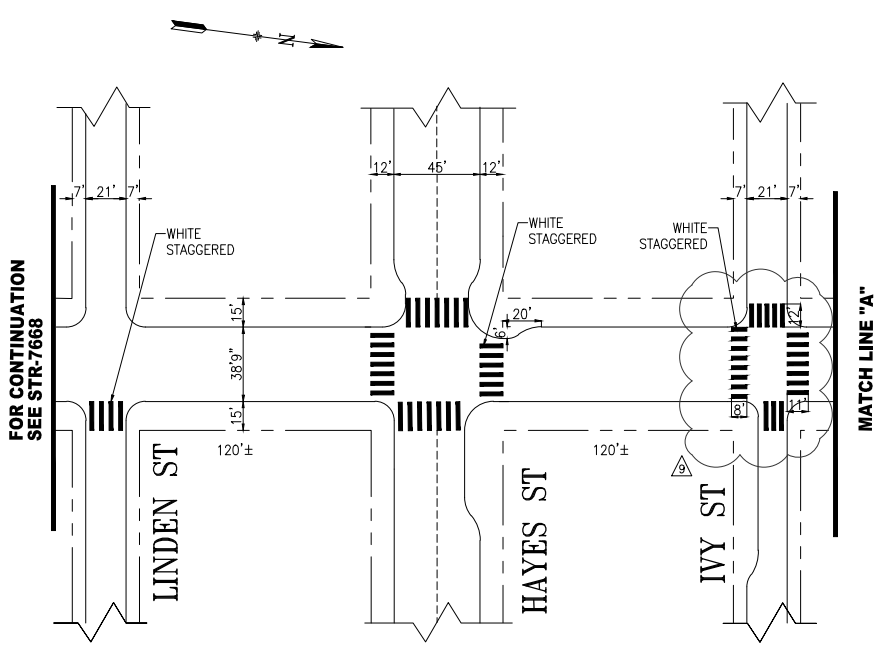

NOTE:
 1. ALL SHARED USE LANE MARKINGS SHALL BE 12'-0" FROM CURB FACE TO CENTER OF MARKING UNLESS OTHERWISE NOTED

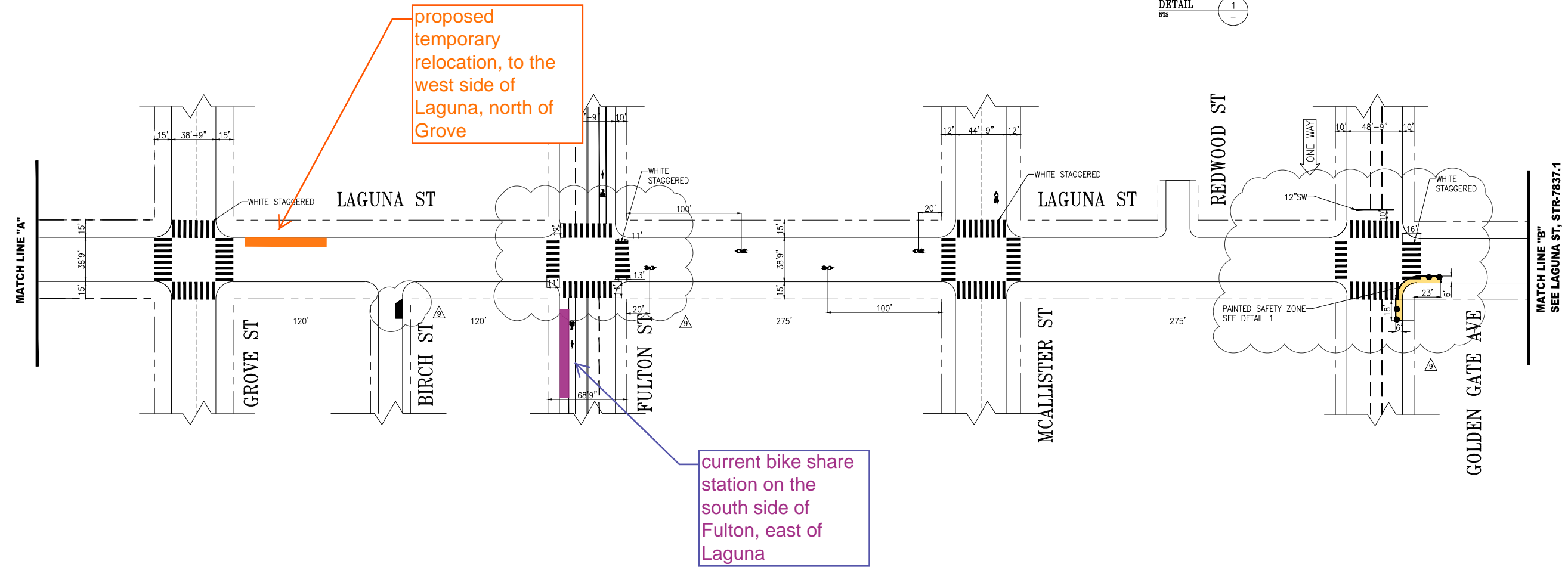

NO.	DATE	DESCRIPTION	BY	APP
10/30/20		ADDED PSZ @ GOLDEN GATE; PER FIELD CHANGED XWALK DIMS @ IVY, FULTON & GOLDEN GATE. PER FIELD ADDED PLANTER BOX @ BIRCH; PER FIELD CHANGED ALL @ GOLDEN GATE.	S.SHARIATI	W.LEE
06/09/18		WHITE STAG CONTI @ LINDEN, HAYES, FULTON, & GOLDEN GATE; ALL @ GOLDEN GATE	J.CHIMENTO	M.SALLABERRY
03/08/18		ADDED STAGGERED WHITE CONTIS AT IVY	C.SKERRIT	B.WOO
12/15/17		PER FIELD: 12" SW CROSSWALKS, CURB BULBS AT HAYES, BULB ON IVY, MOVED CENTER CROSSWALK LINE AT LINDEN	D.CARR	M.SALLABERRY

TABLE OF REVISIONS
 CHECK WITH TRACING TO SEE IF YOU HAVE LATEST REVISION



APPROVED	SCALE:
MIKE SALLABERRY 05/16/11 SENIOR ENGINEER	1" = 50'
DRAWN: J.R.SHAHAMIRI DATE: 12/2009	SHEET/SHEETS: 1 OF 2
CHECKED: D.R.CURTIS DATE: 03/2011	
APPROVED	
RICARDO OLEA 05/16/11 CITY TRAFFIC ENGINEER	

CONTRACT NO.
 STR-7837

DRAWING NO.
 STR-7837

FILE NO.

REV. NO.
 9

STRIPING DRAWING
 LAGUNA STREET
 LINDEN STREET TO GOLDEN GATE AVENUE

FILE NAME: ---
 DATE: ---

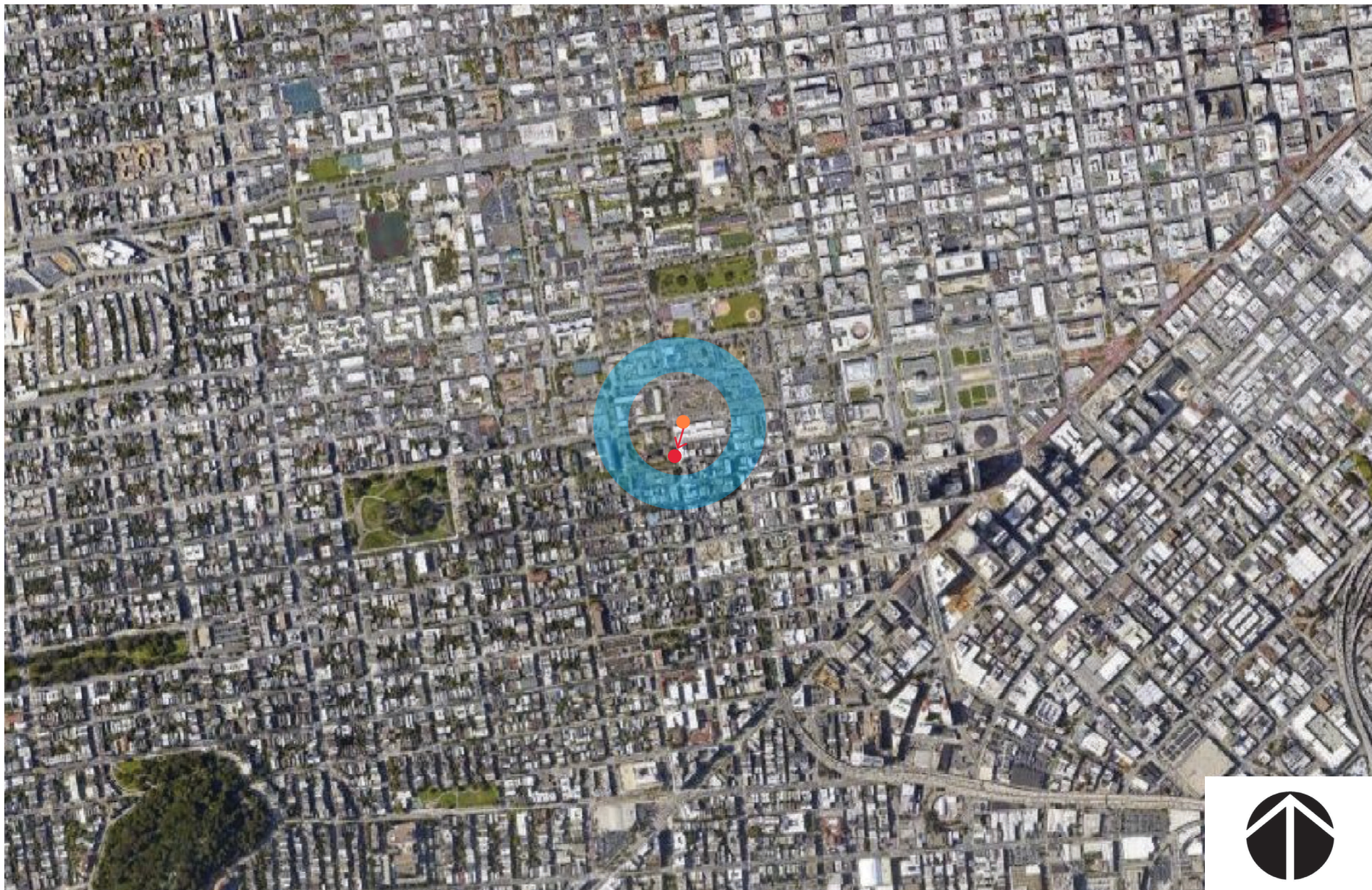

baywheels

Bay Wheels
Aerial Map

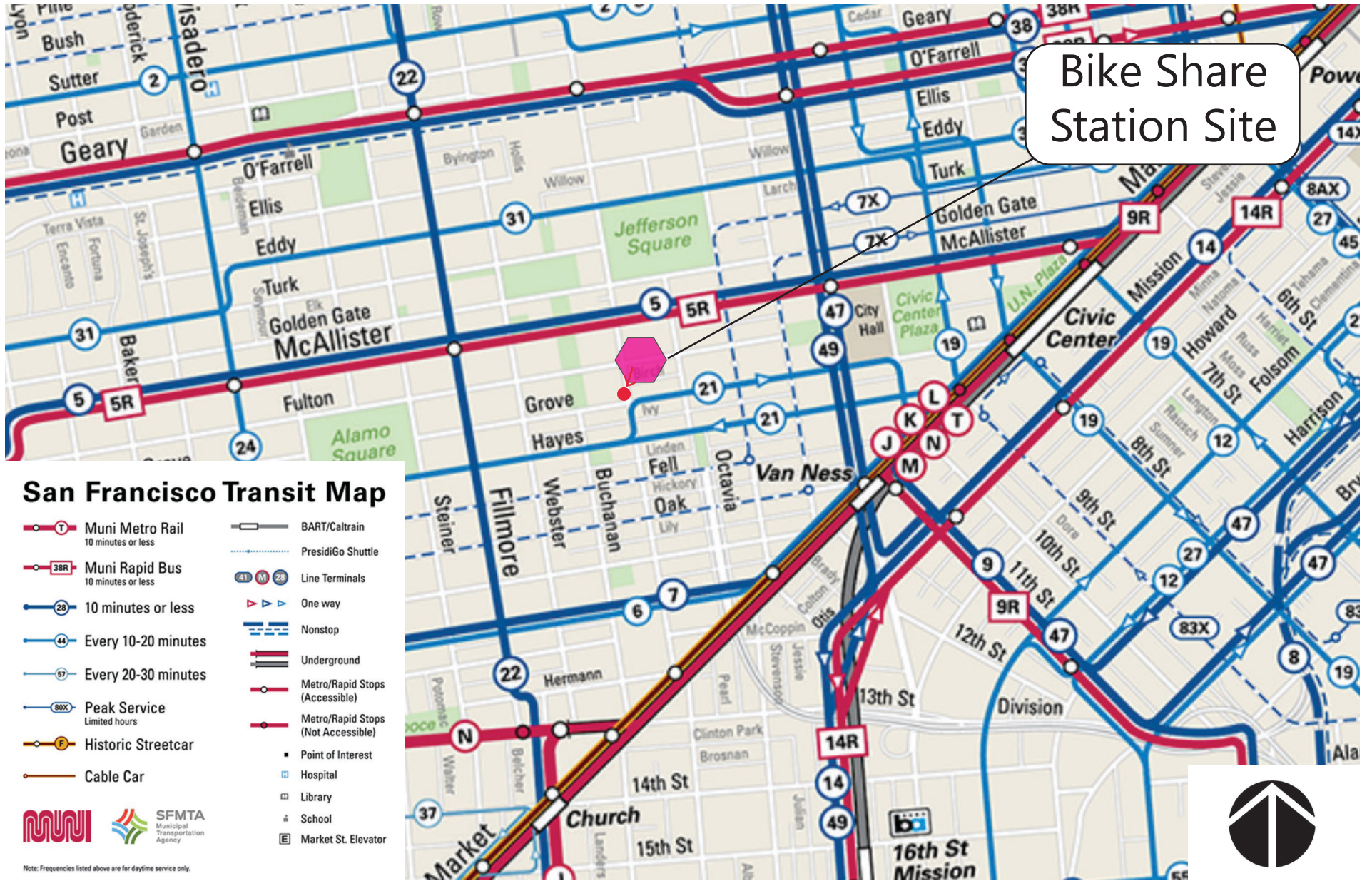

Bike Share Station Site



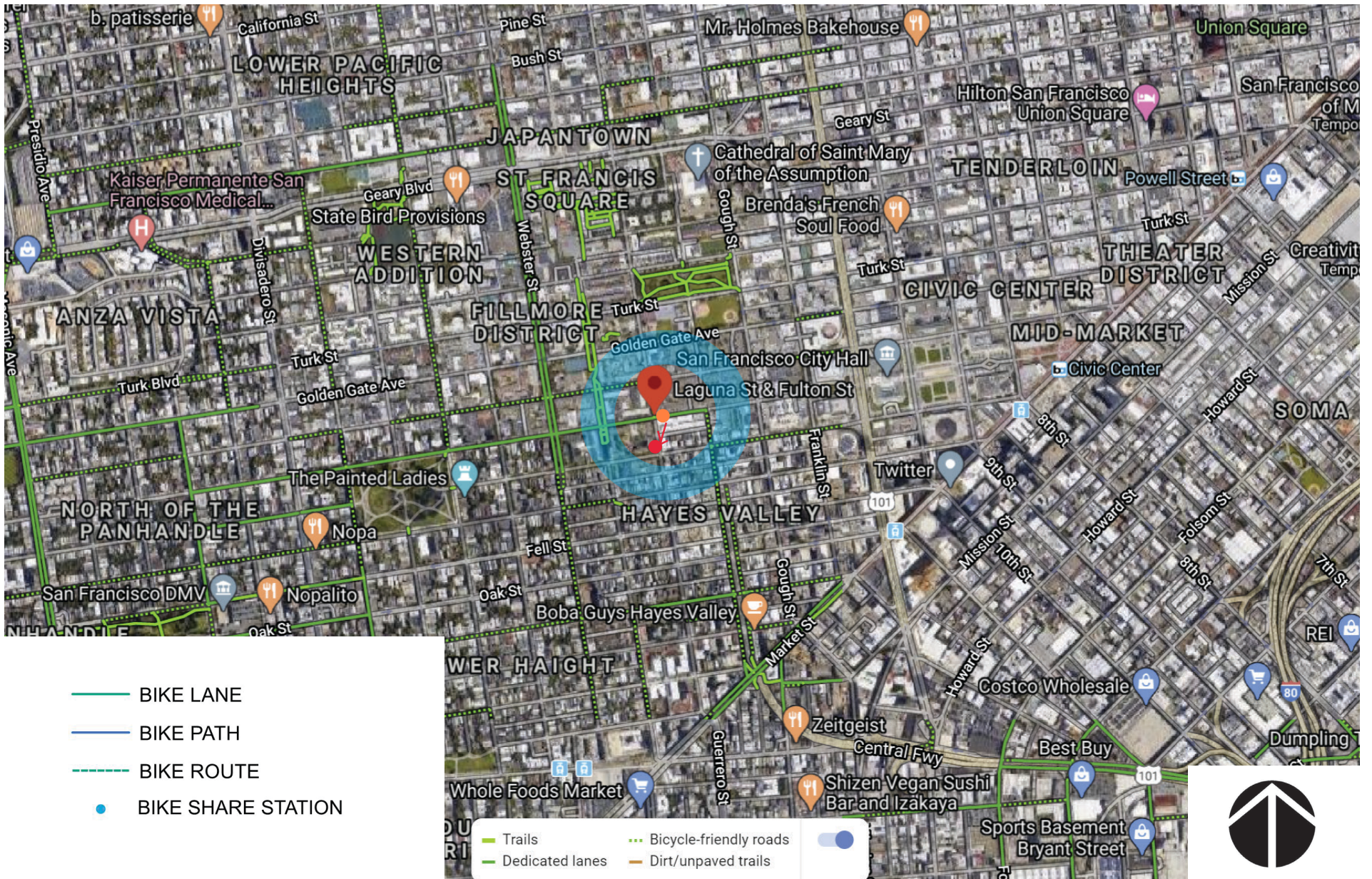



SAN FRANCISCO PLANNING DEPARTMENT

Notice of Exemption

1650 Mission St.
Suite 400
San Francisco,
CA 94103-2479

Reception:
415.558.6378

Fax:
415.558.6409

Planning
Information:
415.558.6377

DEC 22 2015
POSTED TO

Approval Date: December 18, 2015
Case No.: 2015-005492ENV, SFMTA Bay Area Bicycle Share Project
Project Title: Citywide in San Francisco, primarily within the public right-of-way
Zoning: Not applicable, primarily in the public right of way
Block/Lot: Not applicable, primarily in the public right of way
Lot Size: Not applicable, primarily in the public right of way
Lead Agency: San Francisco Planning Department
Project Sponsor: Heath Maddox, San Francisco Municipal Transportation Agency
 415-701-4789
 heath.maddox@sfmta.com
Staff Contact: Debra Dwyer
 415-575-9031
 debra.dwyer@sfgov.org

2015-0600

ENDORSED
FILED
SAN FRANCISCO County Clerk

DEC 22, 2015

by: FANNY WONG
Deputy County Clerk

To: County Clerk, City and County of San Francisco
City Hall Room 168
1 Dr. Carlton B. Goodlett Place
San Francisco, CA 94102

Pursuant to the California Environmental Quality Act (CEQA), the Guidelines of the Secretary for Resources, and San Francisco requirements, this Notice of Exemption is transmitted to you for filing. At the end of the posting period, please return this Notice to the Staff Contact with a notation of the period it was posted.

Attached fee: \$60 filing fee

PROJECT DESCRIPTION:

The San Francisco Municipal Transportation Agency (SFMTA) proposes to implement a city-wide bicycle sharing system in San Francisco as part of the regional Bay Area Bicycle Share (BABS) system described in detail below. The current regional bicycle share system in San Francisco is a pilot project managed by the Bay Area Air Quality Management District (BAAQMD). The regional BABS system will transfer to the Metropolitan Transportation Commission (MTC) for program oversight at the end of 2015. As part of a BABS pilot project initiated on August 29, 2013, the system operator installed approximately 35 bicycle share stations with input from the SFMTA, comprising 350 bicycles within the public right-of-way, located generally in the northeast section of the City. The proposed project would maintain and upgrade the existing 35 pilot bicycle share stations, and expand the BABS system within San Francisco to comprise a total of approximately 450 stations and 4,500 bicycles across the City and County of San Francisco (San Francisco).

DETERMINATION:

The City and County of San Francisco decided to carry out or approve the project on December 18, 2015. The San Francisco Board of Supervisors (BOS) approved a coordination agreement with the Metropolitan Transportation Commission (MTC), other local partners in the East and South Bay, and the bicycle share operator to carry out the Bay Area Bicycle Share Program, which would be overseen in San Francisco by the San Francisco Municipal Transportation Agency (SFMTA) on December 8, 2015. The agreement was provided to Mayor Lee for his signature and becomes effective upon signing or when ten days have passed. A copy of documents related to this action may be examined at the San Francisco Board of Supervisors, City Hall, 1 Carlton B. Goodlett Place Room 244, San Francisco, CA, 94102 in File Number 151144.

- 1. An Exemption from Environmental Review has been prepared pursuant to the provisions of CEQA under:

- Ministerial (Sec. 21080(b)(1); 15268)
- Declared Emergency (Sec. 21080(b)(3); 15269(a))
- Emergency Project (Sec. 21080(b)(4); 15269(b)(c))
- Categorical Exemption, Class 3, Section 15303
- Statutory Exemption, State code number: _____
- Community Plan Exemption (Sec. 21083.3; 15183)

- 2. This project in its approved form has been determined to be exempt from environmental review because it would result in the installation of up to 450 bicycle sharing stations throughout San Francisco, primarily within the public right-of-way and on some parcels. The proposed individual stations are portable, modular, and would be solar and battery powered, and would thus not involve excavation or utility connections. The bicycle sharing station equipment is small in scale and massing relative to surrounding buildings or sites. Bicycle facilities and infrastructure are common sights within the urban environment. There would be no potential for significant environmental impacts at either a project or cumulative level. Therefore, the proposed project would be exempt from environmental review under Class 3.

John Rahaim
Planning Director

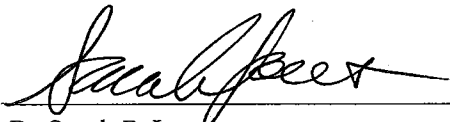
By Sarah B. Jones
Environmental Review Officer

December 22, 2015
Date

cc: Heath Maddox, SFMTA
Interested parties